

**Increase your catch,
Improve the life of
your equipment and
Keep your vessel at sea
longer.**

High performance equipment for fishing.



what makes us unique and valuable to you?

We are problem solvers

Nationwide, our people have the collective knowledge and experience that spans years of service; you benefit from that every day. No matter the industry you are in; Construction, Forestry, Marine or Agriculture if you have a problem, Cookes can solve it. That means better performance and profitability for your business.

International quality from local branches

You can shop at your local Cookes branch for a huge range of world-class industrial products. Our people enjoy making relationships personal. We aim to understand your industry, your business, and your unique needs. What you need is not on the shelf? Or in the warehouse? We can supply products from any of our 11 national branches. Have a problem? We can design and tailor a solution to meet your needs and requirements.

Health and safety come first

Our business revolves around the use and support of industrial machinery where any unsafe practice can lead to serious harm. Safety always comes first. Whether we're manufacturing, testing, certifying or supplying; health and safety is paramount for our employees, contractors, and customers.

We are experts in ensuring that the equipment you use is fit for purpose. Cookes in-house testing, height safety services, mobile testing services, non-destructive testing and specialist rigging services ensure your equipment meets and or exceeds all relevant AS/NZS standards.

Quality Assured

Cookes is absolutely committed to supplying quality products and service. We have held ISO 9001 certification since 1992 and have expanded this to include the ISO 14001 and OHSAS 18001 certification, demonstrating our commitment to quality, sustainability and safety. We have achieved Full Member accreditation with LEEA, the internationally recognised standard in lifting, providing further assurance of our ability to deliver quality solutions that consistently meet or exceed your needs. More recently we have become IANZ accredited for the inspection and testing of wire ropes.

Freephone 0508 274 366
contact@cookes.co.nz
www.cookes.co.nz

CONTENTS

OUR HISTORY	4
OUR BRANDS	6
ROPE TECHNOLOGY	8
TRAWLING	10
PURSE SEINE	38
LONGLINE	46
SPORTS	61
FISH AGGREGATING DEVICE (F.A.D)	66
CRAY FISH	72
ACCESSORIES	76
NET LOFT & NET SERVICES	86
OUR LOCATIONS	88



COOKES: OUR ORGANISATION, OUR HISTORY

Cookes is the name at the very heart of how this country was built: our products have been doing New Zealand's heavy lifting, hauling, hoisting, trawling, digging (and more) for over a century.

Leaders in the supply of commercial fishing products and services.

As the New Zealand brand of Bridon-Bekaert The Ropes Group, Cookes is a leader in the development, manufacturing, sales and testing and inspection of steel wire, synthetic fibre ropes & lubricants. Couple this with our decades of experience working alongside the commercial fishing sector supplying high performance nets, floats and services and you have New Zealand's leader in performance driven solutions for fishing.

market leading solutions for fishing

BRIDON · BEKAERT THE ROPES GROUP

Bridon-Bekaert Ropes Group is the world's premier supplier of mission-critical advanced cords, steel wire ropes, and synthetic fibre ropes.

As a leading innovator, developer and producer of the best performing ropes and advanced cords globally, the Group provides superior value solutions to the oil & gas, mining, crane, elevator and other industrial sectors.

Two of the most enduring wire and rope pioneers joined forces in 2016 to make this ambition real. Bridon-Bekaert Ropes Group has a global manufacturing footprint and employs approximately 2500 people worldwide.



Gourock - supplying New Zealand business since 1900



Cookes established in Auckland 1911



Cookes 1961



1975 Gourock



2013 Cookes & Gourock come together



2016 Cookes a Bridon-Bekaert Ropes Group brand

our partner brands.

AUTHORISED DISTRIBUTORS FOR THE WORLDS LEADING BRANDS

BRIDON

BlueStrand

ScanRope

VAN BEEST

YOKE

DYNAMICA
Ropes ApS

D | S | R

MØRENOT
FISHERY

Gourock

we are active in many industries.



COOKES360

Cookes 360 services:

Technical Advice & Specification

- ✓ Expert knowledge
- ✓ Bespoke solutions
- ✓ Compliance & assurance

Sourcing & Transportation

- ✓ Sourcing quality products
- ✓ Global supplier network
- ✓ Indent supply & expediting

Assembly & Installation

- ✓ Lifting & rigging
- ✓ Height safety
- ✓ Net fabrication

In-service Inspection, Testing & Certification

- ✓ Non-destructive evaluation (NDE)
- ✓ Inspection & testing
- ✓ Certification

Maintenance & Repair

- ✓ Wire & fibre rope
- ✓ Lifting & height safety equipment
- ✓ Netting

Storage

- ✓ Lofting of lifting equipment
- ✓ Storage of customer product
- ✓ Insurance wire rope stock

Asset Management & Compliance

- ✓ BriCert
- ✓ Asset compliance
- ✓ Guidance on discard



Advanced Services

- ✓ Customer training
- ✓ Sales & hire of load measurement solutions
- ✓ VR crane operator training

BBtec

The Bridon-Bekaert Technology Centre (BBtec) is our centre of excellence for rope technology development, testing, analysis and verification.

BBtec is equipped with unique equipment capable of testing steel/synthetic ropes and wires. It has extensive forensic analysis laboratory facilities and specialists capable of conducting detailed forensic evaluations of new or retired ropes.

BBtec accelerates Bridon-Bekaert's new product development, involving the latest rope technologies to increase safety, performance and operational life of ropes working in demanding and hostile environments typical to our core markets in the Oil and Gas, Mining, and Construction sectors.

rope technologies.

Polymer Technologies

PLASTIC IMPREGNATION

High performance plastic impregnation is designed to offer an internal cushioning layer to the inter-strand contact points especially between core to cover on multi-strand low rotation ropes improving bend fatigue and core service life.

NXG

Advanced next generation low friction polymer technology incorporating unique additives to further enhance fatigue life of plasticated ropes

OUR PREMIERE PRODUCT OFFERING WITH POLYMER TECHNOLOGY

starfish[®]

STARFISH ropes construction reduces sheave wear and point to point loading, which combined with the superior dynamic structural stability provided by the Bristar core, ensures exceptional performance.

- ✓ **HIGH PERFORMANCE CONSTRUCTION**
Improved strand positioning significantly increases fatigue life and wear resistance
- ✓ **GREATER INTERNAL ROPE PROTECTION**
Enhanced core life
- ✓ **INCREASED ROPE STABILITY**
Enhanced diameter stability under load improves drum spooling performance and reduces crushing

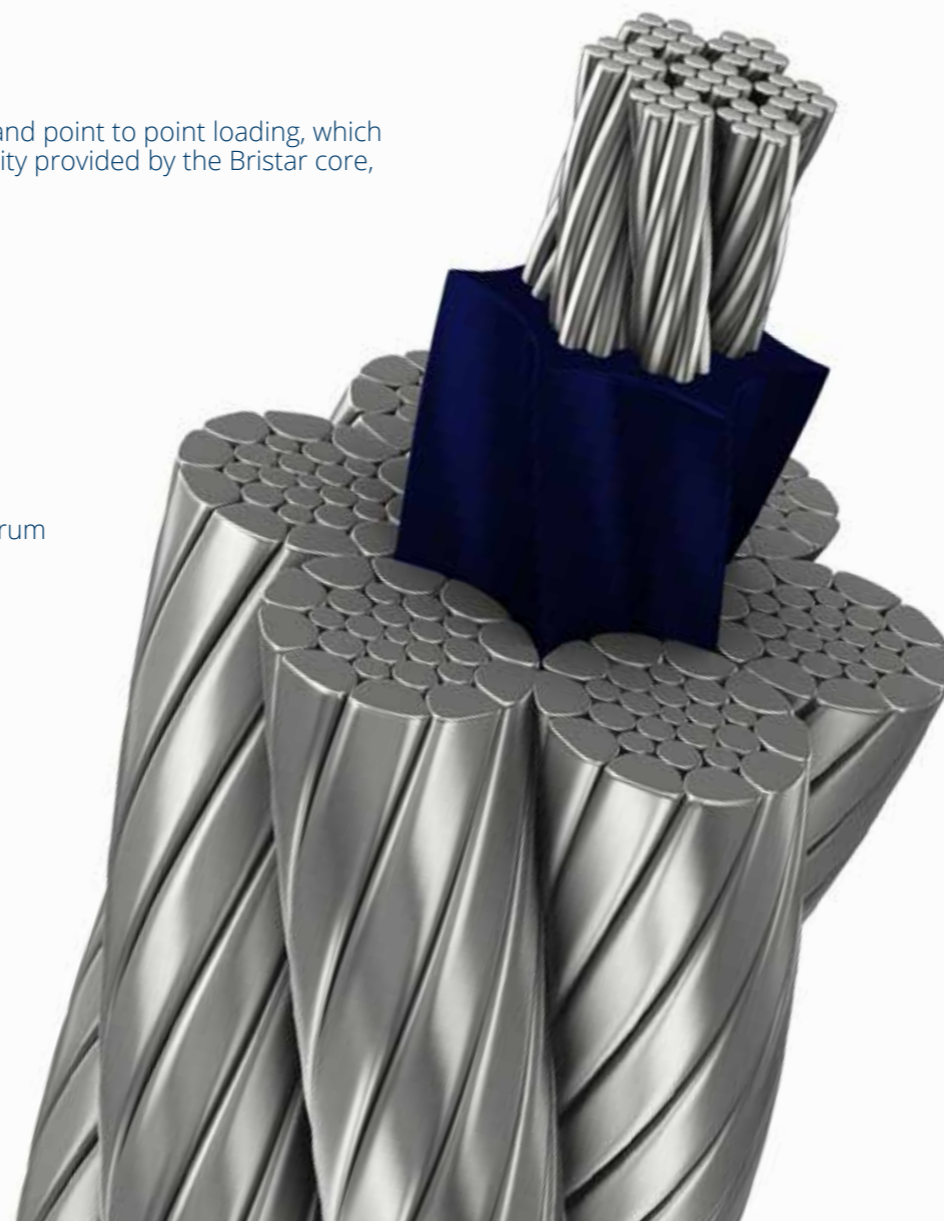

Rope Compaction

DYFORM[®]

Bridon-Bekaert manufactures ropes using a unique dyforming process that compacts the strands as shown below. The smooth surface of the "Dyform" product provides improved rope to sheave contact leading to reduced wear on both rope and sheave. Increased cross-sectional steel area and improved inter - wire contact ensures that the rope will operate with lower internal stress levels resulting in longer bending fatigue life and lower costs.

If abrasion is determined to be a major factor in rope deterioration, then a wire rope with relatively large outer wires should be considered.

Non Dyform wire rope on adjacent drum laps can cause point contact and accelerated wear. Selection of a Dyform product will reduce abrasion through improved contact of the smooth surfaces, creating better contact and longer rope life.

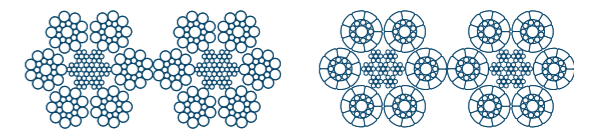
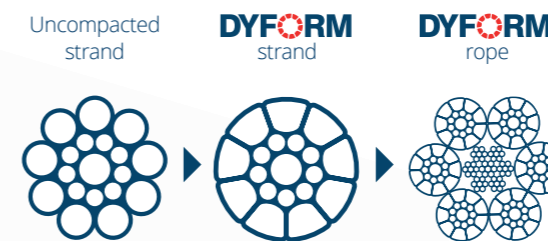

Dyform ropes also reduce rope to sheave abrasion through increased contact of the periphery of the rope with the sheave as shown below.

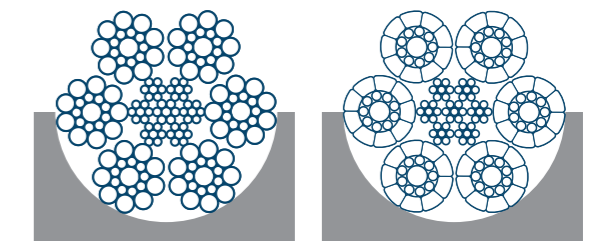

RESISTANCE TO ABSRASIVE WEAR

Abrasive wear can take place between rope and sheave and between rope and drum but the greatest cause of abrasion is often through "interference" at the drum.

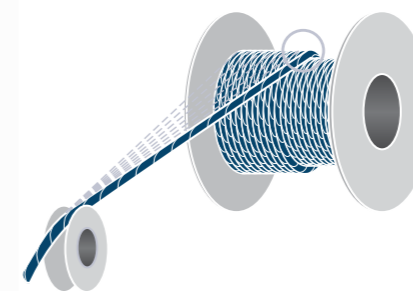

CRUSH RESISTANCE

In multi-layer coiling applications where there is more than one layer of rope on the drum it is essential to install the rope with some back tension. Bridon-Bekaert recommends a minimum installation tension of between 2.5% and 10% of the minimum breaking force of the rope.

If this is not achieved, or in certain applications where high pressure on underlying rope layers is inevitable e.g. a boom hoist rope raising a boom from the horizontal position, severe crushing damage can be caused to underlying layers.

Trawl Warps

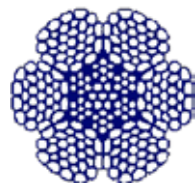

Dyswage

Designed specifically to meet NZ's demanding deep-water trawling needs, Dyswage is a double compacted (strand/rope) trawl warp offering the best diameter retention combined with the highest strength-to-diameter ratio.

Benefits

- ✓ Highest strength to diameter
- ✓ Higher resistance to crushing
- ✓ High surface contact area
- ✓ Reduced elongation
- ✓ Excellent abrasion resistance



Dyform & Dyform Starfish

This premium quality strand compacted trawl warp features a plastic impregnated core preventing core corrosion and providing diameter stability

Benefits

- ✓ High strength
- ✓ Accurate diameter for effective spooling
- ✓ High resistance to crushing



COOKES		Dyswage	
Rope Diameter (mm)	Nominal length mass (kg/m)	Minimum Break Force	
		(kn)	(Tonnes)
6x19S IWRC (1420/177 N/mm ²)			
18	1.64	246.5	25.1
20	2.00	297	30.2
22	2.39	349	35.5
6x26WS IWRC (1420/1770 N/mm ²)			
24	2.72	446.4	45.51
26	3.36	510	54
28	3.8	601	61.2
29.5	4.54	675	68.8
30	4.58	680	69.4
32	5.13	774	78.9

BRIDON		Dyform & Dyform Starfish	
<small>a BRIDON - BEKAERT Ropes Group Brand</small>			
Rope Diameter (mm)	Nominal length mass (kg/m)	Minimum Break Force	
		(kn)	(Tonnes)
6X26WS IWRC (1420/1770 N/MM ²)			
16	1.05	168	17.1
18	1.29	212	21.6
20	1.70	252	26.6
22	1.99	302	30.8
24	2.47	332	33.8
26	2.93	413	42.1
28	3.21	514	52.4
30	3.88	589	60.0
32	4.09	671	68.4

Did you know?



TECHNICAL ADVICE & SPECIFICATION

We are New Zealand's largest & most experienced wire rope and lifting products supplier, and we pride ourselves in our ability to provide expert knowledge & technical advice to our customers.

- ✓ Advice & technology to increase the useful life of your equipment
- ✓ BBtec - The worlds leading wire rope development & technology centre
- ✓ Assurance your assets are fit for their intended purpose.

Trawl Warps



Blue Strand 6 series

Blue Strand 6 series is a range of 6 stranded galvanized fishing ropes available in a variety of constructions in steel and fibre core.

Benefits

- ✓ Fit for purpose, robust rope construction
- ✓ Fully lubricated during manufacture

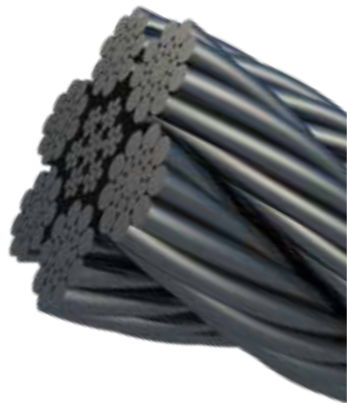

BlueStrand		6 series 6X19				
Rope Diameter (mm)	Nominal length mass IWRC (kg/m)	Minimum Break Force		Nominal length mass Poly Core (kg/m)	Minimum Break Force	
		(kn)	(Tonnes)		(kn)	(Tonnes)
Includes 6x19S, 6x19F, 6x26WS (1420/1770 N/MM2)						
10	0.41	61.7	6.30	0.37	50.9	5.20
12	0.59	91.2	9.30	0.54	81.4	8.30
14	0.80	110	11.20	0.73	105.3	10.70
16	1.02	143	14.57	0.95	137.7	14.00
18	1.29	181	18.45	1.25	168	17.12
19	1.44	199	20.20	1.35	187	19.00
20	1.59	224	22.83	1.45	207	21.10
22	1.99	283	28.85	1.80	251	25.58
24	2.29	322	32.82	2.08	298	30.37
26	2.77	387	39.40	2.45	350	35.67
28	3.16	454	46.20	2.80	406	41.38
30	3.65	521	53.10	3.00	468	47.70
32	4.19	580	59.10	3.70	533	54.30

Torque Resistant Trawl Warps

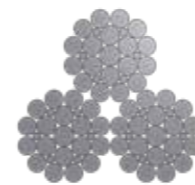

Blue Strand series 3

Fit-for-purpose three-strand torque resistant trawl wrap.



Dyform 3 (3x26WS)

High performance compacted three strand torque resistant trawl warp.

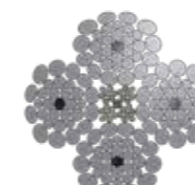

Swage 4 - IWRC

Robust hammer swaged four-strand torque resistant trawl warp with steel core.



Swage 4 - FC

Robust hammer swaged four-strand torque resistant trawl warp with fibre core.



Sweeps & Bottom Bridle

BlueStrand Series 3

Rope Diameter (mm)	Nominal length mass (kg/m)	Minimum Break Force	
		(kn)	(Tonnes)
BLUE STRAND 3 Includes: 3x19F, 3x26WS, 3x31WS & 3x36WS (1420/1770 N/mm2)			
10	0.36	59.2	6.36
11	0.44	73.1	7.45
12	0.52	91.0	9.20
13	0.62	102.8	10.50
14	0.71	115.5	11.77
16	0.95	155.8	15.80
18	1.20	184.4	18.80
19	1.30	213.4	21.76
22	1.79	289.6	29.53
24	2.29	338.9	34.50

BRIDON Dyform 3

Rope Diameter (mm)	Nominal length mass (kg/m)	Minimum Break Force	
		(kn)	(Tonnes)
DYFORM 3 3x26WS (1420/1770 N/mm2)			
14	0.75	120	12.23
16	1.00	185	18.80
18	1.23	196.0	20.63

COOKES Swage 4- IWRC & FC

Rope Diameter (mm)	Nominal length mass (kg/m) IWRC	Minimum Break Force		Nominal Length Mass (kg/m) Poly Core	Minimum Break Force	
		(kn)	(Tonnes)		(kn)	(Tonnes)
4x30WS (1420/1770 N/mm2)						
10				0.40	73	7.44
12				0.58	105	10.70
14	0.87	140	13.50	0.80	132	13.46
16	1.17	188	19.2	1.08	174	17.80
19				1.70	254	25.90

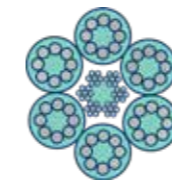

High Performance Sweep Wire

This four- and six-strand combination rope manufactured from galvanised wires covered in a heavy layer of tough danline yarns offers a much larger diameter when compared weight for weight with standard wire ropes. Combination rope is ideal for sweeps and bottom bridles when bottom trawling, sliding over the seabed without penetrating into it.

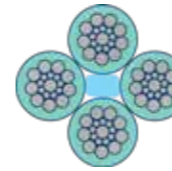

Benefits

- ✓ Durable
- ✓ Suitable for soft & hard sea floor
- ✓ Galvanised



Bonded sweep & bottom bridle wire

PVC coated wire rope for sweep wires when bottom trawling.

Benefits

- ✓ Extra thick abrasion resistant cover
- ✓ Large diameter / weight ratio

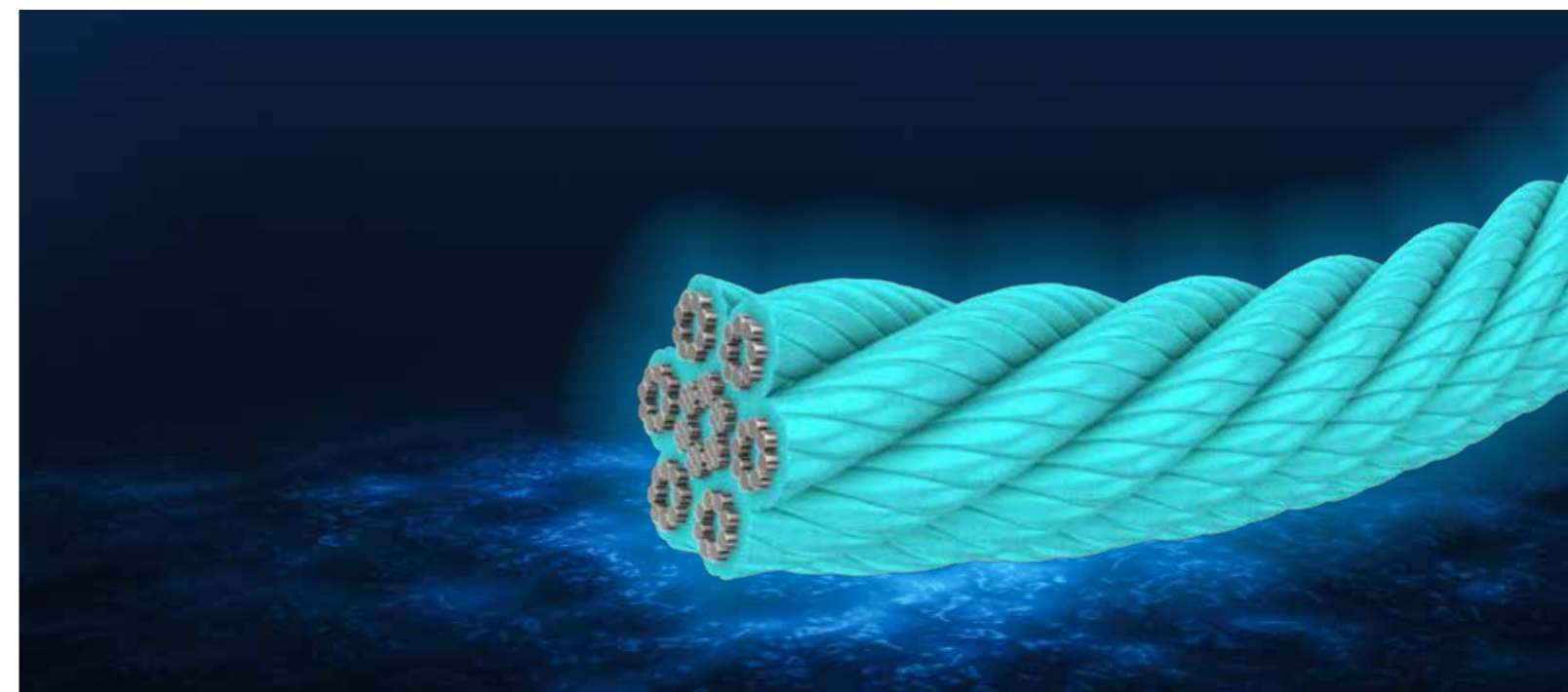
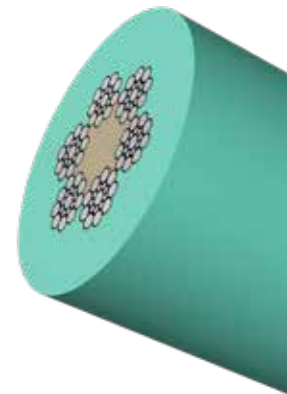

Combination Rope				
Rope Diameter (mm)	Construction	Nominal length mass (kg/m)	Minimum Break Force	
			(kn)	(Tonnes)
4x19 galv combination				
32	4x19	1.18	15.5	1.58
38	4x19	1.38	25.1	2.56
42	4x19	1.68	27.6	2.81
6 STRAND COMBINATION ROPE IWRC				
12	6x6	0.120	37.59	3.80
14	6x8	0.280	45.60	4.60
16	6x8	0.370	61.71	6.20
18	6x8	0.460	74.60	7.60
20	6x8	0.590	95.20	9.70
22	6x8	0.870	139.30	14.20
26	6x8	1.180	186.00	19.00

BRIDON		Bonded Ropes		
a BRIDON BEKAERT Ropes Group Brand				
Rope Diameter (mm)	PVC Diameter	Nominal length mass (kg/m)	Minimum Break Force	
			(kn)	(Tonnes)
6x19S FFC (1420/1770N/mm2)				
14	30	1.69	105.3	10.70
16	32	1.88	137.7	14.04

Dyneema® rope

Dyneema® 12 strand fibre ropes

High strength ropes made from Dyneema®, the world's strongest fibre

Dyneema® is more than ten times stronger than steel per unit of weight. This means that these ropes have a slightly higher strength than a steel wire of the same dimension, but less than one tenth of the weight. After two years of exposure, 80% of strength is retained.

- ✓ The world's strongest fibres
Dyneema®, the world's strongest fiber™, is respected as the premium brand for ultra-high molecular weight polyethylene.
- ✓ Lighter & stronger than steel
10x stronger than steel at the same weights and lengths.
- ✓ Abrasion resistant
High resistance to abrasion, moisture, UV radiation, and chemicals
- ✓ Bend fatigue resistant
The highly flexible properties of Dyneema® fibres ensure excellent resistance to bend fatigue.



Product Code	Diameter	Unit	Weight	Break Load
			kgs/100m	kg
18681063	4 mm	per mtr	1.0	1,400
18681064	5 mm	per mtr	1.4	3,000
18681065	6 mm	per mtr	2.1	4,000
18681085	8 mm	per mtr	3.5	7,700
18681105	10 mm	per mtr	4.6	10,000
18681125	12 mm	per mtr	9.0	17,800
18681145	14 mm	per mtr	12.0	22,000
18681165	16 mm	per mtr	14.0	26,100
18681185	18 mm	per mtr	19.0	36,000
18681205	20 mm	per mtr	22.0	41,000
18681225	22 mm	per mtr	25.5	50,500
18681245	24 mm	per mtr	30.0	55,000
18681265	26 mm	per mtr	32.5	65,000
18681285	28 mm	per mtr	39.0	70,000
18681325	32 mm	per mtr	46.0	84,500
18681365	36 mm	per mtr	60.0	110,000

Fibre rope

SuperDan® Rope

SuperDan rope is manufactured from high tenacity polypropylene yarns offering easy handling, high strength and excellent abrasion resistance.

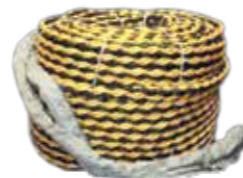

Product Code	Diameter (mm)	Length m	Unit	Weight		Break Load	
				kgs/100m	kg	kg	kN
18010287	28 mm	220	Coil	39.4	14,500	142.2	
18010324	32 mm	220	Coil	51.1	18,500	181.5	
18010365	36 mm	220	Coil	64.1	23,000	225.6	
18010401	40 mm	220	Coil	79.1	28,400	278.6	
18010480	48 mm	220	Coil	114.5	39,800	390.4	
18010568	56 mm	220	Coil	156.0	52,800	518.0	
18010648	64 mm	220	Coil	203.6	68,200	669.0	
18010728	72 mm	220	Coil	258.0	85,800	841.7	
18010806	80 mm	220	Coil	319.0	105,600	1,035.9	

- ✓ **Advanced durability**
Excellent anti-abrasion properties contribute to longer working life (over 10% compared to standard ropes) and high ultra-violet light resistance.
- ✓ **Super Strength**
50% better breaking strength compared to British Standards and ISO standards for polypropylene ropes
- ✓ **Variety of Applications**
A multi purpose rope ideal for general industrial & commercial fishing applications.

Fibre rope

SuperTec 8 strand rope

Product Code	Description	Length m	Unit	Weight	Break Load	
				kgs/100m	kg	kN
18013428	28 mm SuperTec	220	Coil	39.4	17,800	174.6
18013436	36 mm SuperTec	220	Coil	64.1	28,300	277.6
18013440	40 mm SuperTec	220	Coil	79.1	34,900	342.4
18013448	48 mm SuperTec	220	Coil	114.5	48,900	479.7
18013456	56 mm SuperTec	220	Coil	156.0	64,900	636.6
18013464	64 mm SuperTec	220	Coil	203.6	83,900	823.0
18013472	72 mm SuperTec	220	Coil	258.0	105,500	1,034.9
18013480	80 mm SuperTec	220	Coil	319.0	129,900	1,274.3



DSR's innovative technology has enabled us to offer a stronger and more affordable rope. Size for size, SuperTEC is stronger than PP, PE, and polyolefin ropes. In addition to its strength, SuperTec provides higher abrasion and fatigue resistant properties.

SuperTec rope is easier to handle than other ropes of its class, as it does not absorb water.

Available in three, eight and twelve strand.

Available in green only. Other sizes available on indent.



Braids & Twine

Classic Rope - Solid

Description	Dia	Colour	Length	Weight	Br. Load
	mm			m	kgs/100m
Fineline Solid YJ4	4.0	Various	100	1.16	220
Fineline Solid YJ4	4.0	White	100	1.16	220
Fineline Solid YJ6	6.0	White	100	2.77	700
Fineline Solid YJ6	6.0	Various	100	2.77	700
Fineline Solid YJ6	6.0	Black	100	2.77	700
Fineline Solid YJ8	8.0	Black	100	4.97	1,500
Fineline Solid YJ8	8.0	White	100	4.97	1,500
Fineline Solid YJ8	8.0	Various	100	4.97	1,500
Fineline Solid YJ10	10.0	Black	100	7.75	2,500
Fineline Solid YJ10	10.0	White	100	7.75	2,500
Fineline Solid YJ10	10.0	Various	100	7.75	2,500
Fineline Solid YJ12	12.0	Black	100	10.3	3,100
Fineline Solid YJ12	12.0	Blue	100	10.3	3,100
Fineline Solid YJ12	12.0	Red	100	10.3	3,100
Fineline Solid YJ12	12.0	Yellow	100	10.3	3,100
Fineline Solid YJ12	12.0	Various	100	10.3	3,100
Fineline Solid YJ12	12.0	Green	100	10.3	3,100
Fineline Solid YJ14	14.0	Various	100	15.3	4,800
Fineline Solid YJ14	14.0	White	100	15.3	4,800
Fineline Solid YJ16	16.0	White	100	18.1	6,400
Fineline Solid YJ16	16.0	Various	100	18.1	6,400



- ✓ Designed for the cruiser/racer, FINELINE™ polyester double braids are constructed using 100% high tenacity multifilament polyester yarn.
- ✓ High strength with low stretch, softer construction for ease of splicing.
- ✓ Excellent UV and chemical resistance, for use on most yachting applications such as: Sheets, halyards, downhauls, runners, reefing line and spinnaker guys.

Braids & Twine

Nylon Braid Black/White

Description	Dia	Spl Size	Approx. B/S	Approx. Mtr / kg	Packaging (carton)
		kg			
Nylon Braid Black/White	1.0	1	40	650	25 spls
Nylon Braid Black/White	1.5	1	50	550	25 spls
Nylon Braid Black/White	2.0	1	65	370	25 spls
Nylon Braid Black/White	2.5	1	80	270	25 spls
Nylon Braid Black/White	3.0	1	150	200	25 spls
Nylon Braid Black/White	3.5	1	200	140	25 spls
Nylon Braid Black/White	4.0	1	300	85	25 spls
Nylon Braid Black/White	4.5	1	350	60	25 spls
Nylon Braid White	5.0	1	400	50	25 spls
Nylon Braid White	6.0	1	600	40	25 spls
Nylon Braid White	6.0	2	600	80	12 spls
Nylon Braid White	8.0	2	800	50	25 spls



HDPE Braided Netting Twines

Model	Dia	Spl Size	Knot B/S	Mtr / kg	Packaging (tray)
	mm	kg	kg		
Olivene MK3	2.5	1	175	287	12 spls
Olivene MK3	3.5	1	275	190	12 spls
Olivene MK3	4.0	1	330	155	12 spls
Olivene MK3	5.0	1	523	100	12 spls
Olivene MK3	6.0	1.5	725	59	9 spls
Sapphire	2.1	1	161	375	12 spls
Sapphire	3.1	1	299	190	12 spls
Stealth	6.0	1	501	75	12 spls

Braids & Twine

Polyester Staple Netting Twine

Description	Size	Length	Unit	Break Load
	mm	m / 500g		kg
Polyester Staple 10's / 09	0.9	1,000	Spool	25
Polyester Staple 10's / 12	1.2	775	Spool	34
Polyester Staple 10's / 15	1.5	625	Spool	42
Polyester Staple 10's / 18	1.8	520	Spool	50
Polyester Staple 10's / 24	2.4	390	Spool	67
Polyester Staple 10's / 30	3.0	310	Spool	84
Polyester Staple 10's / 36	3.6	260	Spool	100



Gourock Fishing Braids

Description	Size	Material	Reel Size
	mm		m
Fishing Braid	9	Polyester, Dbl Braid	100
Fishing Braid	11	Polyester, Dbl Braid	100
Fishing Braid	13	Polyester, Dbl Braid	100
PP-310L Braid Blue	10	Polypropylene Braid	220
PE-620L Braid Orange	13	Polyethylene Braid	220
Kendju Bentsu Chain Tie	11	PE / PES Braid	300

Polyethylene / Polyester Braided Twines

Model	Dia	Spl Size	Colour	Packaging (carton)
	mm	kg		
Polyblend	3	1	Green / White	25 spls
Polyblend	3	1	Blue / White	25 spls
Polyblend	3	1	Black / White	25 spls
Polyblend	3	1	Red / White	25 spls
Polyblend	3	1	Yellow / White	25 spls
Polyblend	4	1	Green / White	25 spls
Polyblend	5	1	Green / White	25 spls

Trawl Netting

Olivene Trawl Netting

Offering the best combination of abrasion resistance and knot breaking strength for any netting in its class, Olivene is a high-density polyethylene compact braid. It is autoclaved to ensure maximum mesh stability, which enables consistent trawl performance.

Unique identification: Emerald green colour + two orange tracer yarns

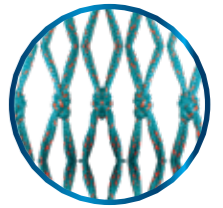

Sapphire Netting

Sapphire netting is the next generation of HDPE compact braid netting. Higher knot breaking strength allows twine diameter downsizing, enabling lower drag resistance while maintaining breaking strength. Size for size, Sapphire is the ultimate HDPE netting on the market.

Unique identification: Sapphire blue with yellow tracer (or reverse - yellow with blue tracer)

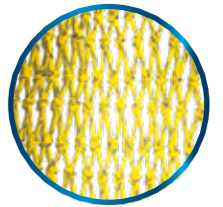

Knotless Codends

Nitto Seimo (Japan) knotless codends are a highly specialised three-strand (3 S/T) braid or twist construction for commercial trawling applications with superior strength and performance over conventional knotted netting.

Made from high-tenacity polyethylene continuous monofilament fibres. 100% twine strength is maintained throughout the mesh intersect.

Reduced drag (less bulk weight) over conventional netting. High abrasion resistance (without knots), netting does not have high "spots" to catch on stern ramps, net rollers, and rough bottoms.

Stable mesh size. Each piece of netting has its own unique "inspection certificate." Nitto Seimo netting maintains nearly 100% of its original mesh size throughout product life.

Reduced damage to fish. Maximises fish quality with less bruising and blood spotting to fillets due to no knot protrusion.

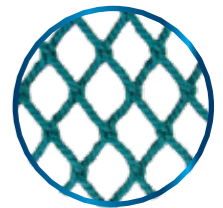

HDPE DCS3



HDPE 3SBK

Did you know?



NETLOFT SERVICES

New Zealand's leading, supplier, manufacturer, and service provider for net solutions. Our team of net makers have over 50 years' experience across the fishing and aquaculture sectors. We pride ourselves on being able to offer high-quality advice and service that add value

- ✓ ets for commercial fishing, aquaculture, and general purpose
- ✓ Manufacture and repair of nets
- ✓ Rope splicing

Olivene MK3 Trawl Netting

Product Code	Model	Twine Size	Mesh Size (KK)		Mesh Type	Bale Mesh (mm)		Bale Weight kg
		mm	in	mm		MD	ML	
17319949	Olivene MK3	2.5	4 1/2	117	Single	100.5	500	55
17319954	Olivene MK3	2.5	6	152	Single	100.5	500	68
17319961	Olivene MK3	2.5	9	229	Single	50.5	1000	94
17319965	Olivene MK3	2.5	12	305	Single	50.5	500	58
17320004	Olivene MK3	3.0	4 1/2	115	Single	50.5	1000	64
17320014	Olivene MK3	3.5	4 1/2	117	Single	100.5	500	82
17320007	Olivene MK3	3.5	6	152	Single	50.5	500	51
17320009	Olivene MK3	3.5	9	229	Single	50.5	500	70
17320052	Olivene MK3	2x 4.0	4 1/2	115	Double	50.5	500	131
17320012	Olivene MK3	3.5	12	305	Single	50.5	500	87
17320041	Olivene MK3	4.0	4 1/2	117	Single	50.5	1000	117
17320066	Olivene MK3	4.0	6	152	Single	50.5	1000	140
17320067	Olivene MK3	4.0	6	152	Single	91.5	1000	250
17320123	Olivene MK3	2x 4.0	6	152	Double	50.5	500	156
17320069	Olivene MK3	4.0	9	229	Single	105	1000	280
17320092	Olivene MK3	2x 4.0	9	229	Double	50.5	500	205
17320120	Olivene MK3	4.0	12	305	Single	50.5	500	124
17321084	Olivene MK3	5.0	4 1/2	117	Single	50.5	500	102
17321089	Olivene MK3	5.0	6	152	Single	50.5	1000	237
17321094	Olivene MK3	2x 5.0	6	152	Double	50.5	500	280
17321095	Olivene MK3	5.0	9	229	Single	50.5	500	160
17321096	Olivene MK3	2x 5.0	9	229	Double	50.5	500	362
17321098	Olivene MK3	5.0	12	305	Single	50.5	500	191
17321100	Olivene MK3	2x 5.0	12	305	Double	30.5	500	257
17321040	Olivene MK3	4.5	5	127	Single	50.5	405	75
17321127	Olivene MK3	2x 5.0	5	127	Double	50.5	405	183
17321280	Olivene MK3	2x 5.5	4	105	Double	50.5	405	244
17321300	Olivene MK3	2x 5.5	5 1/2	140	Double	50.5	450	288
17321326	Olivene MK3	6.0	5	127	Single	50.5	405	159
17321400	Olivene MK3	7.0	4 1/2	115	Single	40.5	405	170

Sapphire Netting

Product Code	Model	Twine Size	Mesh Size (KK)		Mesh Type	Bale Mesh (mm)		Bale Weight kg
		mm	in	mm		MD	ML	
17310100	Sapphire	2.1	4 1/2	114	Single	100.5	500	41
17310125	Sapphire	2.1	6	152	Single	100.5	500	55
17310150	Sapphire	2.1	9	229	Single	50.5	1,000	77

HDPE Braided Netting Twines

Product Code	Model	Dia	Spool Size	Knot B/S	Mtr / kg	Packaging (tray)
		mm	kg	kg		
18880253	Olivene MK3	2.5	1	175	287	12 spls
18880353	Olivene MK3	3.5	1	275	190	12 spls
18880403	Olivene MK3	4.0	1	330	155	12 spls
18880503	Olivene MK3	5.0	1	523	100	12 spls
18880602	Olivene MK3	6.0	1.5	725	59	9 spls
18880308	Sapphire	2.1	1	161	375	12 spls
18880311	Sapphire	3.1	1	299	190	12 spls

Polyethylene/Polyester Braided Twines

Product Code	Model	Dia	Spool Size	Colour	Packaging (carton)
		mm	kg		
18885312	Polyblend	3	1	Green / White	25 spls
18885312B	Polyblend	3	1	Blue / White	25 spls
18885312C	Polyblend	3	1	Black / White	25 spls
18885312R	Polyblend	3	1	Red / White	25 spls
18885312Y	Polyblend	3	1	Yellow / White	25 spls
18885412	Polyblend	4	1	Green / White	25 spls
188885512	Polyblend	5	1	Green / White	25 spls

Knotless Codends (Netting only)

Product Code	Material	Construction	Twine Dia.	Dimensions	Mesh Size
			mm		mm IM
17029606	HDPE 3SBK	3 S/T Braid	5.8	80MR x 50MD	127
17029616	HDPE 3SBK	3 S/T Braid	9.1	150MR x 50MD	103
17029618	HDPE 3SBK	3 S/T Braid	9.1	100MR x 50MD	103
17029692SL	HDPE DCS3	3 S/T Twist	10.0	75MD x 35MTR	63
1702952C	HDPE DCS3	3 S/T Twist	10.0	75MD x 35MTR	103

Trawl Chain

Cookes is proud to distribute quality mid and long link trawl chain.

Mid Link Trawl Chain

Product Code	Size	MBL* t	Dimensions (mm)		Weight kg/m
	mm		Inside Length	Inside Width	
026351136	13	21.4	52	22	3.4
02635016G	16	32.2	64	24	5.1
02635019G	19	45.4	76	29	7.2

- ✓ Grade 80 high strength special steel hardened and tempered.
- ✓ Excellent resistance to shock loading and wear.



Long Link Trawl Chain

Product Code	Size	MBL* t	Dimensions (mm)		Weight kg/m
	mm		Inside Length	Inside Width	
02636013G	13	21.4	80	23	2.9

- ✓ Grade 80 high strength special steel hardened and tempered.
- ✓ Excellent resistance to shock loading and wear.

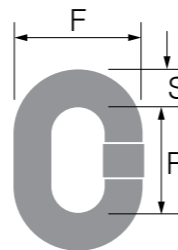

Mid Link Trawl Chain

Product Code	Size	MBL* t	Dimensions (mm)			Weight kg/m
	mm		S	R	F	
02635022	22	61	22	88	76	9.4

- ✓ Grade 80 special alloy steel, hardened and tempered.
- ✓ Self-colour finish.
- ✓ Manufactured in Norway.

Trawl Chain

Cookes is proud to distribute quality mid and long link trawl chain.

Mid Link Trawl Chain

Product Code	Chain Size	MBL t	Dimensions (mm)			Weight kg/m
	mm		S	R	F	
02635113	13	21.6	12.7	50.8	45.8	3.0
02635216G	16	32.7	16.0	59.6	57.3	5.1
02635219G	19	46.2	19.0	76.0	66.5	7.2

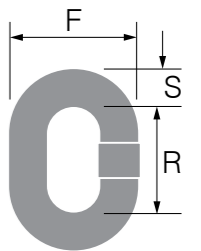

Long Link Trawl Chain

Product Code	Chain Size	MBL t	Dimensions (mm)			Weight kg/m
	mm		S	R	F	
02636213	13	21.6	12.7	80.5	49.0	2.9

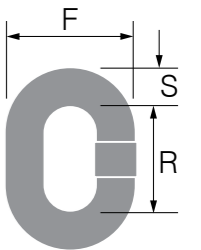

Grade 95 Trawlex® Chain

Crosby Trawlex® trawl chain with improved resistance to stress corrosion and optimised for low temperature conditions.

Product Code	Size	MBL* t	Dimensions (mm)			Weight kg/m
	mm		S	R	F	
02400516	16	41.0	16	64	54.5	4.90
02400519	19	57.0	19	76	65.0	6.95

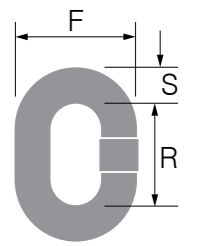

*MBL = Minimum Breaking Load

- ✓ Manufactured from high strength, wear and shock resistant special steel.
- ✓ Self colour finish.
- ✓ Manufactured in France.

Shackles & Connectors

Green Pin Hi-Load - Bow Trawl Shackles

Product Code	WLL (ton)	Body Dia D (mm)	Pin Dia d (mm)	Inside Width a (mm)	Inside Length C (mm)	Width of Bow 2r (mm)
02314322	4.75	19	22	31	76	51
02314326	W6.50	22	25	36	83	58
02314328	8.50	25	28	43	95	68
02314332	9.50	28	32	47	108	75
02314335	12.00	32	35	51	115	83
02314338	13.50	35	38	57	133	92
02314342	17.00	38	42	60	146	99
02314351	25.00	45	50	74	178	126

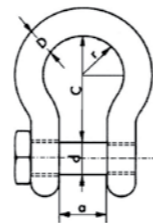

Green Pin Hi-Load - Dee Trawl Shackles

Product Code	WLL (ton)	Body Dia D (mm)	Pin Dia d (mm)	Inside Width a (mm)	Inside Length C (mm)
02314216	2.00	13	16	22	43
02314219	3.25	16	19	27	51
02314222	4.75	19	22	31	59
02314225	6.50	22	25	36	73
02314228	8.50	25	28	43	85
02314232	9.50	28	32	47	90
02314235	12.00	32	35	51	94
02314238	13.50	35	38	57	115
02314242	17.00	38	42	60	127

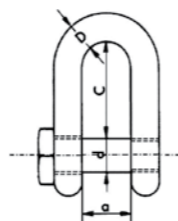

Gourock Connecting Link

Product Code	WLL	G80 Chain	Dimensions (mm)				Weight kg
	t	mm	A	B	D	K	
02500410	3.15	10	25	26	11	68	0.3
02500413	5.3	13	30	35	16	91	0.7
02500416	8.0	16	36	38	19	100	1.1
02500420	12.5	18 - 20	42	46	22	122	1.9



Connectors & Swivels

YOKE Connecting Link - Type YA

Product Code	Yoke Item No.	WLL	G80 Chain	Dimensions (mm)				Weight kg
		t	mm	A	B	D	K	
02459006	8-015-06	1.12	6	15	17	7	44	0.08
02459007	8-015-07	2.0	7, 8	18	22	9	57	0.2
02459010	8-015-10	3.15	10	25	26	11	68	0.3
02459013	8-015-13	5.3	13	30	35	16	91	0.7
02459016	8-015-16	8.0	16	36	38	19	100	1.1
02459019	8-015-20	12.5	18 - 20	42	46	22	122	1.9
02459022	8-015-22	15.0	22	49	59	24	152	3.0
02459026	8-015-26	21.2	26	55	62	30	162	5.0
02459032	8-015-32	31.5	32	69	79	36	202	9.0

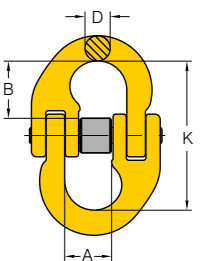

Thrust Bearing Swivels

Product Code	WLL	Proof Load	Dimensions (mm)					Weight (kg)
	ton	ton	A	B	C	D	E	
07265016	1.5	3	123	82	16.5	16	40	0.5
07265031	3	6	167	137	28.5	20	64.5	2
07265061	6	12	243	169	34	30	85	5
07265101	10	20	303	213	40	38	106	11
07265150	15	30	303	213	40	38	106	16

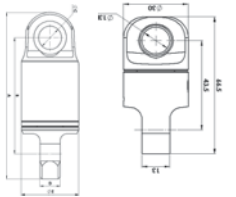

- ✓ Compact and rugged design, 5:1 Safety factor, SKF thrust bearing.
- ✓ Fully serviceable, fully sealed, greaseable, zinc plated for corrosion resistance.
- ✓ Eyes will accept Shackles and Hammerlocks, proof loaded to two times WLL.
- ✓ Also available in Clevis - Eye or Clevis - Clevis configuration (Eye - Eye shown).

Stainless Steel Midget Strawline Swivels

Product Code	WLL	Proof Load	Dimensions (mm)				
	ton	ton	A	B	C	D	E
07250010	0.5	1.0	66.5	43.5	13	13	30



- ✓ Compact and durable design, 5:1 safety factor, proof loaded to two times WLL.
- ✓ Fully machined 316 stainless steel construction for maximum corrosion resistance.
- ✓ Fully ball raced for smooth swivel action & long service life.

Connectors & Links

Recessed Links

Product Code	Model	Link Type	Dimensions (mm)			Weight kg	SWL ton
			Dia.	W	H		
17182470E	EVM 100	Master	21	78	142	0.8	10
17182471E	EVM 120	Master	25	98	172	1.7	12
17182472E	EVM 150	Master	30	135	230	2.8	15
17182473	EVM 200	Master	34	153	253	4.2	20
17182488E	EVR 08	Recessed	15	97	175	1.4	8
17182490E	EVR 10	Recessed	17	140	205	2.5	10
17182492E	EVR 15	Recessed	17	150	185	3.6	15
17182494	EVR 20	Recessed	41	185	225	5.1	20



G-Hooks

Product Code	Model	Hook Type	Dimensions (mm)		Weight kg	SWL ton
			W	H		
17182443E	EVG 03	G-Hook	70	115	0.65	3
17182445E	EVG 05	G-Hook	82	132	1.2	5
17182450	EVG 10	G-Hook	115	180	3.3	10
17182455	EVG 15	G-Hook	136	215	6.05	15
17182460	EVG 20	G-Hook	155	240	8.40	20

Recessed Link & G-Hook Combination Options

	Model	G-Hooks				
		EVG 03	EVG 05	EVG 10	EVG 15	EVG 30
Recessed Links	EVM 100	✓	✓			
	EVM 120			✓		
	EVM 150			✓	✓	
	EVM 200					✓
	EVR 08	✓	✓			
	EVR 10			✓		
	EVR 15				✓	
	EVR 20					✓

Connectors & Links

Viking Links

Product Code	Model	Link Type	Dimensions (mm)		Weight kg	SWL ton
			W	H		
17183025E	DV 30	Split	70	115	0.7	3
17183027E	DV 50	Split	80	130	1.1	5
17183028E	DV 80	Split	90	145	1.6	8



- ✓ Material: Alloy Steel, Drop Forged & Heat Treated
- ✓ Grade 80
- ✓ Safety Factor: 5:1

Split Links (sister clips)

Product Code	Model	Link Type	Inside Dimensions (mm)			Weight kg	SWL ton
			Dia.	W	H		
17551740	DS 10 SS	Split	10	16	50	0.085	0.2
17551741	DS 12 SS	Split	13	18	55	0.15	0.3
17551742	DS 16 SS	Split	16	21	72	0.33	0.4
17551743	DS 19 SS	Split	19	24	80	0.5	0.5
17551744	DS 22 SS	Split	22	27	88	0.75	0.6

Kellys Eye

Product Code	Model	Link Type	Inside Dimensions (mm)			Weight kg	SWL ton
			Dia.	W	H		
17183040	E90 - 25	Kellys Eye	25	135	220	2.8	7
17183046	E90 - 40	Kellys Eye	40	205	310	9.8	19



Half Bow Hammerlocks - Made in Japan

Product Code	Model	Hook Type	Dimensions (mm)			Weight kg	SWL ton
			Dia.	W	H		
17182219	SKS-BP 19	Connector	19	—	240	3.3	15.5
17182220	SKS-BP 22	Connector	22	—	255	3.8	12.8



Hooks & Blocks

Slip Hooks

Product Code	Model	Hook Type	Dimensions (mm)			Weight kg	SWL ton
			Height	Eye	Width		
17182591	BS 06	Slip Hook	165	18	32	0.8	1
17182592	BS 10	Slip Hook	254	19	48	1.8	1.5
17182593	BS 12	Slip Hook	320	27	49	3.4	2.8
17182595	BS 15	Slip Hook	385	36	40	8.8	7
17182596	BS 16	Slip Hook	385	36	64	15	11



Yoyo Hooks

Product Code	Model	Hook Type	Dimensions (mm)		Weight kg	SWL ton
			W	H		
17182603	BY 30	Yoyo Hook	170	280	2.2	3



BMM Blocks (Blueline) - Galvanised, Steel Sheave

Product Code	Model	Bearing Type	SWL (ton)	Max Wire (mm)	Dim. (mm)		Sheave Dia. mm	Weight kg
					H	W		
17182821	KT 1 - 1E (Sgl sheave)	Ball Bearing	1.0	16	163	22	80	1.7
17182821A	KT 1D - 1E (Dbl sheave)	Ball Bearing	1.0	16	187	44	80	3.1
17182822	KT 1 - 1E (Sgl sheave)	Sealed Ball Bearing	2.0	18	195	24	110	3.1
17182822A	KT 1D - 1E (Dbl sheave)	Sealed Ball Bearing	2.0	18	224	48	110	5.2



BMM Blocks (Blueline) - Snatch Block, Bronze Bushing

Product Code	Model	Top Head	SWL ton	Height mm	Sheave		Weight kg
					Dia	Width	
17182841	KS 20 - E	Swivel eye	1.5	220	83	45	5.4
17182842	KS 40 - E	Swivel eye	3.5	250	100	45	7.5



BMM Blocks (Blueline) - Galvanised, Nylon Sheave

Product Code	Model	Top Head	SWL ton	Max Wire mm	Height mm	Sheave		Weight kg
						Dia	Width	
17182843	KS 2 - OE	Swivel eye	2.0	18	225	110	24	3.7

Hooks & Blocks

BMM Blocks (Blueline) - Galvanised, Nylon Sheave

Product Code	Model	SWL (ton)	Max Wire (mm)	Dim. (mm)		Sheave Dia. mm	Weight kg
				H	W		
17182837	KT 1 - NE (Sgl sheave)	1.0	16	163	22	80	1.3
17182837A	KT 1D - NE (Dbl sheave)	1.0	16	187	44	80	1.9
17182838	KT 2 - NE (Sgl sheave)	2.0	18	195	24	110	2.1
17182838A	KT 2D - NE (Dbl sheave)	2.0	18	224	48	110	3.3
17182839	KT 3 - NE (Sgl sheave)	3.0	20	257	28	150	4.1
17182839A	KT 3D - NE (Dbl sheave)	3.0	20	296	56	150	6.6



- ✓ The Safe Working Load (SWL) indicates the maximum mass or force that the block is able to support.
- ✓ All blocks must be inspected regularly to monitor condition.
- ✓ Each block may be affected by wear, misuse, overloading, deformation and other use conditions.
- ✓ Shock loading and abnormal conditions must be taken into account when selecting blocks.

BMM Blocks (Blueline) - Trawl Blocks

Product Code	Model	Top Head	SWL ton	Height mm	Sheave		Weight kg
					Dia	Width	
17182891	K 130 - OEG	Swivel eye	4.0	374	130	100	16.0
17182892	K 170 - 1E	Swivel eye	6.0	458	170	100	25.0



- ✓ The SWL indicates the maximum mass or force that the block is able to support.
- ✓ All blocks must be inspected regularly to monitor condition.
- ✓ Each block may be affected by wear, misuse, overloading, deformation and other use conditions.
- ✓ Shock loading and abnormal conditions must be taken into account when selecting blocks.

Did you know?



TESTING & CERTIFICATION

Ensuring your assets are in top working order is vital for the smooth and safe running of your business. As New Zealand's largest third-party testing and inspection service provider for lifting equipment, you can be assured we have the industry knowledge and expertise to ensure your assets are certified and safe.

Our LEEA accredited technicians are trained to inspect, test, evaluate, and advise on the condition of your assets.

Trawl Floats

Trawl Floats

Product Code	model*	Type	Body Dia	Working Depth	Nett Buoyancy	Weight	Eye Dia.
			mm	m	kg	kg	mm
17060183	8B-3	CH	240	300	6.1	1.2	23
17060208	10B-8	CH	290	800	3.15	10.8	28
17060245	6B-10	CH	170	1,000	2	0.76	20
17060250	7B-15	CH	200	1,500	2.75	1.6	23
17060263	7M-5	DL	210	500	4.4	1.15	14.5
17060305	HS-300	DL	300	500	12	3.2	—
17060308	HS-300I	DL	300	800	10	4.1	—
17066040	#551 Nokalon	CH	200	400	3.1	0.9	20
17066045	#557 Nokalon	CH	200	1,300	2.4	1.6	20
17066018	#629 Nokalon	DL	230	1,800	4.0	2.8	20
17066025	#511 Nokalon	CH	280	950	7.5	3.4	20

*CH - Centre Hole
DL - Double Lug

UBE Trawl Floats

Two types of UBE Trawl Floats are available: UBE Double Lug Floats and UBE Center Hole Floats, depending on midwater or bottom trawl, fishing waters, and size of trawl net.

Product Code	Type*	Body Dia.	Working Depth	Nett Buoyancy	Weight	Eye Dia.
		mm	m	kg	kg	mm
17062440	CH	360	800	16	7.2	32
17063612	DL	360	1,200	15	8.7	28
17063615	DL	360	1,500	13.3	9.8	28

*CH - Centre Hole
DL - Double Lug



Trawl doors



KIWI

The Injector KIWI is based on the same principle as the multifunction Sparrow model. By re-designing and updating foils and curves, the Injector KIWI is more powerful, more efficient, and a stronger multifunction trawl door than Injector Sparrow. Furthermore, the KIWI design is a lower weight than the Sparrow, without compromising the strength and quality of the door.

Size in M2	Weight in KG
1,0	150
1,5	300
2,0	450
2,5	650
3,0	750
3,5	900
4,0	1000
4,5	1100
5,0	1300
5,5	1500
6,0	1800
6,5	2100
7,0	2300
7,5	2600
8,0	2900
8,5	3200
9,0	3400
9,5	3600
10,0	3800
10,5	4000
11,0	4200
11,5	4400
12,0	4600
12,5	4700
13,0	5000
13,5	5200
14,0	5500
14,5	5700
15,0	5900

KIWI has the same injector main wire pin bracket as Sparrow, with three horizontal and vertical adjustments.

The KIWI model trawl door is a high-aspect bottom door. However, the KIWI allows the vessel to use the same door in bottom trawls, pelagic fishing, and everything in between.

Benefits

- ✓ Higher spreading power
- ✓ Lighter to tow
- ✓ Stronger construction
- ✓ Lighter in weight



Trawl doors



VORTEX

Injector Vortex is based on the same injector principles as the legendary Shark model that revolutionised trawl door technology in 1998.

The Vortex model is specially designed for smaller bottom trawlers where it is essential not to use heavy trawling gear. By adjusting various aspects, such as foil curves, foil overlapping, and foil lengths, Injector was able to make a door that is significantly lighter without compromising the strength and quality that the Shark door was known for.

Size in M2	Size in sq feet	Weight in kg	Length in feet	Length in inches
1,0	10,8	140	4,1	49,6
1,5	16,2	210	4,9	59,3
2,0	21,6	315	5,7	68,5
2,5	27,0	410	6,4	76,4
3,0	32,4	480	7,0	83,5
3,5	37,8	575	7,5	90,0
4,0	43,2	640	8,0	96,0
4,5	48,6	730	8,5	101,9
5,0	54,0	850	9,0	107,6
5,5	59,4	975	9,4	112,5

Benefits

- ✓ High spreading power
- ✓ Lighter to tow
- ✓ Stronger construction
- ✓ Lighter in weight



"Other sizes / weights on request
 Vortex is produced with welded wear plates on keel as standard
 0,0033 to ft / ft to 308,8
 0,0393 to inches / inches to 25,4"

Trawl doors

ADMIRAL

The new pelagic trawl door model from Injector, The Admiral is based on the same principle and technology as the Injector multifunction Kiwi model. Injector has taken the popular pelagic model Monarch a step further to give the Admiral a significant higher lift with a low drag (resistance) ratio.

ADMIRAL	Standard	Heavy	Extra Heavy
Size in M2	Weight (KG)	Weight (KG)	Weight (KG)
1,0	130	170	210
2,0	255	335	390
3,0	550	650	730
4,0	750	950	1030
4,5	800	1100	1180
5,0	1000	1300	1400
5,5	1300	1600	1700
6,0	1500	1800	1900
6,5	1800	2100	2200
7,0	2000	2300	2500
7,5	2200	2500	2700
8,0	2300	2700	2900
8,5	2400	2800	3100
9,0	2500	2900	3200
9,5	2600	3000	3300
10,0	2650	3100	3400
10,5	2700	3200	3500
11,0	2800	3300	3700
11,5	3000	3500	3900
12,0	3100	3600	4000
12,5	3200	3700	4100
13,0	3300	3800	4200
13,5	3400	3900	4300
14,0	3500	4000	4400
14,5	3600	4100	4500
15,0	3800	4300	4700
Other sizes / weights on request			

In addition, the Injector Admiral design makes it possible to make the doors lighter in weight compared with the same size of Injector Monarch without compromising strength, quality, and balance stability.

The first Injector Admiral set was tested on Polar Amaroq for Blue Whiting Fishing with great success.

Benefits

- ✓ High spreading power
- ✓ Lighter to tow
- ✓ Stronger construction
- ✓ Lighter in weight



Purse seine



Pacific Blue - Purse Wires

Pacific Blue

Pacific Blue is a compacted strand wire rope recommended for purse seining. The rope features large outer wires for increased abrasion resistance and a smooth surface suitable for purse rings.

* Available in steel or fibre core

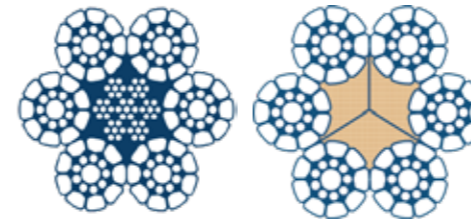

Benefits

- ✓ Increased abrasion resistance
- ✓ Reduced wear from roller rings
- ✓ High fatigue resistance



PRODINSA		Pacific Blue				
Rope Diameter (mm)	Nominal length mass (kg/m) iwrc	Minimum Break Force		Nominal length mass (kg/m) (Poly Core)	Minimum Break Force	
		(kn)	(Tonnes)		(kn)	(Tonnes)
6x19S (1420/1770N/mm ²)						
20	1.83	277	25.7	1.60	249	25.4
22	2.25	342	34.9	1.90	308	31.4
24	2.60	399	40.7	2.30	359	46.6
26	3.10	469	47.8	2.70	401	40.9
28	3.6	543	55.4	3.10	488	49.8
30	4.1	612	62.4	3.60	548	55.8
32	4.7	696	71	4.00	623	63.5



Tuna net chain

ACCO Tuna Chain

ACCO uses high-quality steel, specially formulated and heat treated for tuna fishing. Every heat-treated lot is sampled and destructively tested for material strength and link elongation, assuring compliance to designed criteria. All Tuna Net Chains are then proof tested, 100%, every link.

The ACCO Tuna Net Chain is continuously hot-dip galvanised to provide the deep, strong protective coating you have come to expect, which has over 30% more zinc per unit volume than mechanical coating.

In the hot-dip process, the galvanised zinc coating is alloyed with the base steel, creating a metallurgical bond that is several orders of magnitude stronger than mechanical bonding.

- ✓ Hot dip galvanised
- ✓ Tested and certified
- ✓ Manufactured in the U.S



Product Code	ACCO Item No.	Dimensions (mm)			MWL** t	Weight (kg)		Length (m)	
		Diameter	Inside Length	Inside Width		m	Drum	Drum	
02614010*	520140692	10	33.8	14.5	3.00	2.2	268	122	
02614011*	520140792	12	34.8	19.1	3.97	3.2	291	91	
02614013*	520140892	13	43.7	19.1	5.12	3.8	232	61	
02614014*	520140992	14	43.2	21.6	5.50	4.5	275	61	
02614016*	520141092	16	49.3	23.1	7.17	5.7	257	45	

Did you know?



ASSET MANAGEMENT

Our cloud-based asset management system, BriCert, provides the ideal way to manage and certify your assets.

BriCert allows you to:

- ✓ Manage the locations of all your assets across multiple sites.
- ✓ Ensure your assets are always inspected and certified.
- ✓ Have an up-to-date service history of your assets.

Fittings

Green Pin® Standard Bow Shackles – Screw Collar Pin

Product Code	WLL t	Dimensions (mm)										Weight kg
		a	b	c	d	e	f	g	h	i	j	
02325019	3.25	16	19	40	16	27	64	43	110	89	75	0.63
02325022	4.75	19	22	46	19	31	76	51	129	103	89	1.01
02325026	6.50	22	25	52	22	36	83	58	144	119	102	1.50
02325028	8.50	25	28	59	25	43	95	68	164	137	118	2.21
02325032	9.50	28	32	66	28	47	108	75	185	153	131	3.16
02325035	12.00	32	35	72	32	51	115	83	201	170	147	4.31
02325038	13.50	35	38	80	35	57	133	92	227	186	162	5.55
02325042	17.00	38	42	88	38	60	146	99	249	203	175	7.43

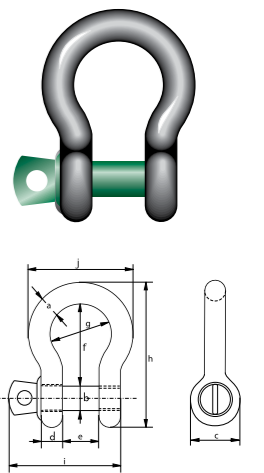

Quenched and tempered high-tensile Grade-6 steel shackles with hot-dip galvanised finish.

- ✓ 6:1 design factor
- ✓ Tested and certified.
- ✓ Manufactured in The Netherlands.

Crosby G-209 "Red Pin" Bow Shackles

Product Code	WLL t	Dimensions (mm)											Weight kg
		A	B	C	D	E	F	G	H	L	M	P	
02216009	0.75	13.5	9.65	31.0	7.85	21.3	19.1	37.3	53.0	5.60	42.2	7.85	0.09
02216011	1.00	16.8	11.2	36.6	9.65	26.2	23.1	45.2	63.0	6.35	51.5	9.65	0.14
02216013	1.50	19.1	12.7	42.9	11.2	29.5	26.9	51.5	74.0	7.85	60.5	11.2	0.17
02216016	2.00	20.6	20.6	47.8	12.7	33.3	30.2	58.5	83.5	9.65	68.5	12.7	0.33
02216019	3.25	26.9	19.1	60.5	16.0	42.9	38.1	74.5	106	11.2	85.0	17.5	0.62
02216022	4.75	31.8	22.4	71.5	19.1	51.0	46.0	89.0	126	12.7	101	20.6	1.07
02216026	6.50	36.6	25.4	84.0	22.4	58.0	53.0	102	148	12.7	114	24.6	1.64
02216028	8.50	42.9	28.7	95.5	25.4	68.5	60.5	119	167	14.2	129	26.9	2.28
02216032	9.50	46.0	31.8	108	29.5	74.0	68.5	131	190	16.0	142	31.8	3.36



Purse Blocks

KP300 Purse Block

WLL 5:1	Max load on firm eye headfitting	A	B	B1	D	E	F	G	H	H1	I	Weight
ton	kg	mm	mm	mm	mm	mm	mm	mm	mm	mm	mm	kg
10	20	690	120	125	300	60	250	240	90	60	39	84
15	30	780	120	125	370	70	260	285	97	99	60	133

At request all blocks are available with:
 Tested, with certificate.
 Flame hardened sheave.
 Firm Eye.



KP300 Sheaves

B	D	R	S	Weight
mm	mm	mm	mm	kg
120	300	80	35	29.80
120	370	100	45	50.50



KP300 Pins

X	Y	Z	Weight
mm	mm	mm	kg
190	35	133	1.50
234	45	162	3.20



KP500 Purse Block

WLL 5:1	A	B	B1	D	E	F	G	Weight
ton	mm	mm	mm	mm	mm	mm	mm	kg
11	680	120	124	300	62	247	240	88
13	902	119	127	370	64	250	305	118
20	1137	180	185	500	75	410	380	425
30	1247	180	185	600	93	410	480	555

At an extra charge all blocks are available with:

- Swivel eye
- Swivel fork
- Swivel shackle eye
- Icedavit eye
- Tested with certificate
- Flame hardened sheave



Purse Seine Floats

Gourock Purse Seine Floats

High performance floats for purse seine fishing. Our floats are made from Ethylene Vinyl Acetate (EVA) material and are available in a range of sizes and shapes to suit your requirements.

Gourock Floats

Product Code	Model	Nett Buoyancy	Weight	Dimensions (mm)		
		kg	g	L	OD	HD
17068269	SHE-25	2.4	370	177	152	28
17068265	SHE-30	3.0	438	180	169	33
17068270	SHE-40	3.8	585	208	185	37
17068280	SHE-70	6.5	1,000	250	220	42
17068285	SHE-85	8.5	1,314	265	248	48



Gourock EVA Floats

Product Code	Model	Nett Buoyancy	Dimensions (mm)			Colour
		kg	L	Dia.	Hole.	
17068315	SHBB-1	5.00	365	153	25	Yellow / White
17068316	SHBB-2	5.70	365	178	25	Yellow / White



Benefits

- ✓ Ethylene Vinyl Acetate (EVA) floats are an ideal surface float
- ✓ Impact resistant - do not break, shrink or deform.
- ✓ Do not absorb water.
- ✓ Light weight with maximum surface buoyancy.
- ✓ Weather and U.V. resistant.

Fibre ropes

Nylon double braided rope

Our high strength nylon double braided rope has low elongation compared to other eight stranded ropes, making them perfect for purse seine applications.

Colour	Diameter (inches)	Length (mtr)
White	½"	183
White	5/8"	183
White	7/8"	183
White	1"	183
White	1.5"	183
White	2"	183
White	2.5"	183
White	3"	183



Benefits

- ✓ Highly flexible
- ✓ Non-rotational construction
- ✓ Shock absorbent

Danline

Colour	Description	Length	Unit	Weight	Break Load
		m		kgs/100m	kg
White/Black/Yellow/Green	6 mm Danline	220	Coil	1.7	600
White/Black/Yellow/Green	7 mm Danline	220	Coil	2.3	820
White/Black/Yellow/Green	8 mm Danline	220	Coil	3.0	1,100
White/Black/Yellow/Green	10 mm Danline	220	Coil	4.5	1,600
White/Black/Yellow/Green	12 mm Danline	220	Coil	6.5	2,200
White/Black/Yellow/Green	14 mm Danline	220	Coil	9.0	3,000
White/Black/Yellow/Green	16 mm Danline	220	Coil	11.5	3,800
White/Black/Green	20 mm Danline	220	Coil	18.0	5,800
White/Black/Green	24 mm Danline	220	Coil	26.0	8,100
White/Black/Green	32 mm Danline	220	Coil	46.0	13,500



Purse Netting & Twine

Purse netting and twine

Construction	Ply	Runnage	Breaking Strength
		Mtrs/ Kg	(Kgf)
210 D/4 x 3	210/12	3386	18
210 D/6 x 3	210/18	2207	28
210 D/8 x 3	210/24	1626	38
210 D/12 x 3	210/36	1075	57
210 D/14 x 3	210/42	882	66
210 D/16 x 3	210/48	790	77
210 D/18 x 3	210/54	686	86
210 D/20 x 3	210/60	632	95
210 D/24 x 3	210/72	527	115
210 D/36 x 3	210/108	348	169
210 D/56 x 3	210/168	220	253
210 D/78 x 3	210/234	157	300
210 D/112 x 3	210/336	110	479
210 D/160 x 3	210/480	69.2	656
210 D/240 x 3	210/720	49.5	948



Longline



Siltlon monofilament

Haesung Siltlon Reel

Siltlon premium-grade monofilament for branch line, snood material. Siltlon premium-grade monofilament has exceptional softness (supple) and transparent (clear) qualities that are required by commercial longline fishermen.



Product Code	Model	Dia. mm	Colour	Load		Length
				kg	lb	
17245459	Siltlon 900 lb	3.00	Clear White	400	900	8,050
17245460	Siltlon 900 lb	3.00	Light Blue	400	900	8,050
17245463	Siltlon 930 lb	3.20	Light Blue	420	900	8,050
17245465	Siltlon 1,100 lb	3.50	Light Blue	500	1,100	8,050
17245467	Siltlon 1,100 lb	3.50	Clear White	500	1,100	8,050
17245473	Siltlon 1,300 lb	4.00	Light Blue	590	1,300	8,050
17245480	Siltlon 1,800 lb	5.00	Clear White	810	1,800	1,000

- ✓ Excellent breaking strength
- ✓ High abrasion resistance

Haesung Marinmax Snood Monofilament

Product Code	Model	Dia MM mm	Colour	Load		Length
				kg	lb	
17245410A	Marinmax 130lb	.90mm	Light Green	59	130	1,000mtr
17245410B	Marinmax 140lb	1.00mm	Light Green	65	140	1,000mtr
17245717	Marinmax 480lb	1.80mm	Fluoro	200	450	1,000mtr
17245722	Marinmax 560lb	2.00mm	Fluoro	225	500	1,000mtr



Siltlon snood monofilament

Haesung Siltlon Hank / Reels

Product Code	Dia. mm	Spool Type	Colour	Load		Length
				kg	lb	
17245410	0.90	Hank	Clear White	45	100	1,000
17245413	1.00	Hank	Clear White	54	120	1,000
17245421	1.20	Hank	Clear White	68	150	1,000
17245426	1.40	Hank	Clear White	90	200	1,000
17245428	1.50	Hank	Clear White	113	250	1,000
17245431	1.60	Hank	Clear White	126	280	1,000
17245435	1.80	Hank	Clear White	158	350	1,000
17245445	2.00	Hank	Clear White	200	440	1,000
17245446	2.00	Hank	Light Blue	200	440	1,000
17245449	2.20	Hank	Clear White	225	500	500
17245454	2.50	Hank	Clear White	270	600	500
17245438	1.80	Reel	Clear White	158	350	8,200
17245446A	2.00	Reel	Light Blue	200	440	6,600
17245480	5.00	Reel	Clear White	810	1,800	1,000



Rockline Stopped Backbone

Product Code	Dia. mm	Stopped at meter	Spool type	Colour	Load		Length
					kg	lb	
17246574	1.30	2.00	Hank	Green	105	230	1,000
17246575	1.80	2.00	Hank	Green	158	350	1,000
17246576	2.20	1.50	Hank	Green	230	500	1,000
17246577	2.50	1.20	Hank	Green	270	600	1,000
17246578	3.00	1.00	Hank	Clear White	400	900	1,000
17246573	5.00	1.20	Reel	Clear White	810	1,800	1,000



Custom stoppering can be made upon request.

Hooks & floats

Gourock Surface Line Hooks

Offset forged C- and T-type Gourock surface line hooks are made from stainless steel and sold in packs of 100.

Product Code	Hook type		Size	material	quantity
17142799	C-TYPE	Offset	14/0	Stainless Steel	100 pcs
17142801	C-TYPE	Offset	16/0	Stainless Steel	100 pcs
17142802	T-TYPE	Offset Forged	14/0	Stainless Steel	100 pcs
17142802A	T-TYPE	Offset Forged	15/0	Stainless Steel	100 pcs
17142803	T-TYPE	Offset Forged	16/0	Stainless Steel	100 pcs
17142803A	T-TYPE	Offset Forged	17/0	Stainless Steel	100 pcs

Bottom Line Hooks

Marinmax 7152H and Morenot high-carbon steel circle hooks are available in packs of 100.

Product Code	Model	Properties	Size	Material	Quantity
17140809	Marinmax 71525H	Offset, Kirbed, Large Eye	9/0	High Carbon Steel	100 pcs
17140810	Marinmax 71525H	Offset, Kirbed, Large Eye	10/0	High Carbon Steel	100 pcs
17140811	Marinmax 71525H	Offset, Kirbed, Large Eye	11/0	High Carbon Steel	100 pcs
17140812	Marinmax 71525H	Offset, Kirbed, Large Eye	12/0	High Carbon Steel	100 pcs
17140813	Marinmax 71525H	Offset, Kirbed, Large Eye	13/0	High Carbon Steel	100 pcs
17140814	Marinmax 71525H	Offset, Kirbed, Large Eye	14/0	High Carbon Steel	100 pcs
17141115	Morenot Circle Hook	Offset, Kirbed, Ringed & Heavy Wire	15/0	High Carbon Steel	100 pcs

Bottom Line Floats

Gourock bottom line floats feature an 11 mm eye diameter.

Product Code	Model	Body Dia.	Working Depth	Nett Buoyancy	Weight	Eye Dia.
		mm	m	kg	kg	mm
17060259	4M-10	120	1,000	0.71	0.31	11
17060262	5M-12	150	1,200	1.65	0.64	11



Hooks, clips and blocks

Snapper Hooks

Tainawa 220R, Morenot Tainawa, & Mustad Tainawa high-carbon steel Snapper Hooks range in size from 16R to 18 R and are sold in packs of 100.

Product Code	Model	Properties	Size	Material	Packaging
17142322	Morenot Tainawa	Ringed, Tinned	17 R	High Carbon Steel	per 100 pcs
17142016	Tainawa 220R	Ringed, Tinned	16 R	High Carbon Steel	per 100 pcs
17142018	Tainawa 220R	Ringed, Tinned	18 R	High Carbon Steel	per 100 pcs
17142316	Mustad Tainawa	Ringed, Tinned	16 R	High Carbon Steel	per 100 pcs
17142317	Mustad Tainawa	Ringed, Tinned	17 R	High Carbon Steel	per 100 pcs
17142318	Mustad Tainawa	Ringed, Tinned	18 R	High Carbon Steel	per 100 pcs



Dyrkorn Snooded Hooks

High-carbon steel snooded hooks are available with or without loop.

Product Code	Snood Size	Hook Size	Loop
17139405	16 Gauge (2.5 mm) x 23" Long	12/0	With Loop
17139416	24 Gauge (3.5 mm) x 23" Long	15/0	Without Loop



Snapper Longline Clips

Gourock JVI and Leigh clips are available in packs of 100.

Code	Model	Dia	Length	Type	Application	Quantity
17551497	Gourock JVI Clip	1.50mm	.53mm	To suit 1.3 to 1.8 mono	Monofilament	100
17551499	Gourock JVI Clip	1.50mm	.53mm	To suit 2.0 to 2.5 mono	Monofilament	100
17551498	Gourock JVI Clip	1.50mm	.53mm	To suit 3.0 mono	Monofilament	100
17551501	Gourock Leigh Clip	1.50mm	.53mm		Monofilament	100

Snapper Longline Blocks

Gourock Longline blocks with grease nipple and ball bearing are available in open and closed single-sheave options.

Code	Size (inch)	Sheave		Block Type	
17182804	4"	Single	Open	Ball Bearing	Grease Nipple
17182805	4"	Single	Closed	Ball Bearing	Grease Nipple

Snap clips

Stainless Steel Snaps with Swivels

Stainless steel type L snap clips with SBL style swivel.

Product Code	Size (mm)		Type	Application	Swivel	Unit
	Dia.	L				
17551474	2.60	100	L Type	Monofilament	SBL	each
17551475	3.50	125	L Type	Monofilament	SBL	each
17551476	2.60	115	L Type	Monofilament	SBL	each
17551694	3.75	140	A Type	Monofilament	60g Leaded	each
17551695	3.75	140	A Type	Monofilament	SBL	each
17551731	2.00	80	A Type	Monofilament	4/0 Crane	each
17551735	2.60	115	U Type	Monofilament	5/0 Crane	each
17551736	3.10	125	L Type	Monofilament	SBL	each



Stainless Steel Snaps

Stainless steel type L snap clips with no swivel

Product Code	Size (mm)		Type	Application	Unit
	Dia.	L			
17551680H	3.50	125	L Type	Rope	each
17551710	2.60	100	L Type	Rope	each
17551730	2.00	80	L Type	Rope	each



Dyrkornline SC

A 50% polyester, 50% danline rope with various spacings and stations. Available in a range of sizes.

Product Code	Dia.(mm)	Spacing (m)	Stations (m)	Length (m)
17400057	7.2	1.4	193	270
17400062	9.2	1.4	128	180
17400064	11.5	1.4	128	180
17400067	12	1.4	128	180



Crimps

Aluminium Crimps

Alloy single and double aluminium crimps in a range of sizes to suit your requirements.

Product Code	Model	Shape	Pack Size	Dimensions (mm)			Material
				W	H	L	
17460502	Alloy Single	Oval	1,000	5.2	10.5	18	Aluminium
17460507	Alloy Single	Oval	1,000	3.3	7.0	18	Aluminium
17460508	Alloy Single	Oval	1,000	3.1	6.3	18	Aluminium
17460509	Alloy Single	Oval	1,000	2.6	5.2	18	Aluminium
17460510	Alloy Single	Oval	1,000	2.3	4.6	18	Aluminium
17460511	Alloy Single	Oval	1,000	2.0	4.2	18	Aluminium
17460512	Alloy Single	Oval	1,000	1.7	3.6	18	Aluminium
17460512A	Alloy Single	Oval	1,000	1.5	3.3	18	Aluminium
17460519	Alloy Double	Oval	1,000	4.2	9.0	20	Aluminium
17460518	Alloy Double	Double	1,000	4.5	7	20	Aluminium



Copper Crimps

Copper double aluminium crimps in a range of sizes to suit your requirements.

Product Code	Model	Size	Shape	Pack Size	Dimensions (mm)			Material
					W	H	L	
17460536	Copper 12	12	Double	1,000	0.8	2.6	7	Copper
17460537	Copper 11	11	Double	1,000	1.0	2.6	7	Copper
17460538	Copper 10	10	Double	1,000	1.3	3.0	7	Copper
17460539	Copper 9	9	Double	1,000	1.6	3.5	9.5	Copper
17460540	Copper 8	8	Double	1,000	1.9	4.2	14	Copper
17460541	Copper 7	7	Double	1,000	2.2	4.6	14	Copper
17460550	Copper 6	6	Double	1,000	2.3	5.0	14	Copper



Swivels

Crane Swivels

Product Code	Model	Type	Size	Colour	Pack per
17391555	BRTWIN-1/0	Rounded Body	1/0	Nickel Black	1,000 pcs
17391561	BRTWIN-2/0	Rounded Body	2/0	Nickel Black	1,000 pcs
17391545	BRTWIN-5/0	Rounded Body	5/0	Nickel Black	1,000 pcs



Heavy Duty Swivels

Product Code	Model	Type	Size	Test Load	
				lb	kg
173911310	Brass Tuna	Heavy Duty Brass (Black)	7	500	227
17391308	Brass Tuna	Heavy Duty Brass	8	750	340
17391309	Brass Tuna	Heavy Duty Brass	9	950	431



Leaded Swivels

Product Code	Model	Break Load	Weight	Unit
		kg	g	
17391701	Leaded 45GM	520kg	45g	each
17391702	Leaded 60GM	520Kg	60g	each



Rolling Swivel

Product Code	Model	Size	Material	Pack per
17391588	Swivels - rolling	8/0	Black	100 Pcs
17391589	Swivels - rolling	9/0	Black	100 pcs



Floats

Longline Floats

Cookes offers a comprehensive range of fit for purpose longline floats. Available in different sizes and working depths.

Product Code	Model	Body Dia.	Working Depth	Nett Buoyancy	Weight	Eye Dia.
		mm	m	kg	kg	mm
17060259	4M-10	120	1,000	0.71	0.31	11
17060262	5M-12	150	1,200	1.65	0.64	11
17065408	HF 240B	240	300	6	1.3	—
17065410	HF 300B	300	300	14.5	2	20
17065420	HF 360C	360	300	20	4.2	—



Gourock EVA Floats

Product Code	Model	Nett Buoyancy	Dimensions (mm)			Colour
		kg	L	Dia.	Hole.	
17068315	SHBB-1	5.00	365	153	25	Yellow / White
17068316	SHBB-2	5.70	365	178	25	Yellow / White

Benefits

- ✓ Ethylene Vinyl Acetate (EVA) floats are an ideal surface float
- ✓ Impact resistant - do not break, shrink, or deform
- ✓ Do not absorb water, light weight with maximum surface buoyancy
- ✓ Weather and UV resistant

Floats

Polyform Inflatable Marker Buoys

Product Code	Model	Nett Buoyancy	Eye Dia.	Dimensions (mm)			Colour
	Polyform	kg	mm	L	Dia.	Circ.	
17063700	A-0	6	16	290	230	722	Red
17063702	A-0	6	16	290	230	722	Yellow
17063710	A-1	13	25	370	290	911	Red
17063711	A-1	13	25	370	290	911	Green
17063712	A-1	13	25	370	290	911	Yellow
17063713	A-1	13	25	370	290	911	White
17063720	A-2	31	28	490	390	911	Red
17063730	A-3	55	28	590	470	1,476	Red
17063740	A-4	85	28	710	550	1,727	Red
17063750	A-5	179.6	30	920	700	2,198	Red
17063760	A-6	359.2	38	1,180	860	2,700	Red



Benefits

- ✓ Ropeholds and valves built to withstand the most severe applications.
- ✓ Redesigned ropeholds for A-1 through A-7 for improved strength and durability.
- ✓ Dual valve inflation/deflation system for sizes A-5, A-6 & A-7.
- ✓ Excellent rafting fender choice.

Polyform inflatable low drag buoys

Inflatable low drag buoys from Polyform. These floats offer high UV resistance and a ribbed design that creates reduced drag compared to standard round buoys.

Polyform low drag buoys are offered in a range of colours & designs.

Product Code	Model	Nett Buoyancy	Eye Dia.	Dimensions (mm)			Colour
	Polyform	kg	mm	L	Dia.	Circ.	
17063690	LD-1	13	25	470	215	270	Orange
17063691	LD-1	13	25	470	215	270	Red
17063692	LD-2	31	25	590	305	377	Red
17063692A	LD-2	31	25	590	305	377	Yellow
17063692B	LD-2	31	25	590	305	377	Orange
17063692C	LD-2	31	25	590	305	377	Saturn Yellow
17063693	LD-3	55	25	760	360	449	Red



- ✓ Unique upright shape ensures maximum visibility.
- ✓ Ribbed design creates only 20% of the drag of standard round buoys.

Floats & Bins

Polyform Inflatable CC Marker Mooring Buoys

Product Code	Model	Nett Buoyancy kg	Eye Dia. mm	Dimensions (mm)			Colour
	Polyform			L	Dia.	Circ.	
17063715	CC-1	12	38	390	280	879	Red
17063725	CC-2	25	50	480	360	1,130	Red
17063735	CC-3	55	50	700	550	1,476	Red
17063745	CC-4	85	50	700	550	1,727	Red
17063755	CC-5	170	75	920	700	2,198	Red



Reinforced flexible centre tube (always insert rigid pipe/tube before inflation)
Variety of applications:

- ✓ Mooring buoy
- ✓ Oceanic research equipment.
- ✓ Offshore fishing

Leader Bins

Product Code	Model	Size	Dimensions (mm)		
			L	W	H
17551471	Haesung Leader Bin - 3 Wire	500 Hooks	865	530	620
17551472	Haesung Leader Bin - 3 Wire	300 Hooks	745	525	690



Tuna trolling gear

Tuna Hex Heads

Product Code	Model	Number of Eyes	Eye	Weight
				g
17460651	Tuna Hex Head	6	Blue	42
17460652	Tuna Hex Head	6	Red	42
17460666	Tuna Hex Head	6	Red	70
17460665	Tuna Hex Head	6	Blue	70



Tuna Skirts

Product Code	Model	Type	Colour	Unit
17561094	Triple Skirt	TS1	Zucchini	Three Per Pkt
17561095	Triple Skirt	TS2	Mexican Flag	Three Per Pkt
17561096	Triple Skirt	TS3	Purple/Pink	Three Per Pkt
17561097	Triple Skirt	TS4	Pink/White	Three Per Pkt
17561098	Triple Skirt	TS5	Purple/Black	Three Per Pkt
17561099	Triple Skirt	TS6	Green/Orange	Three Per Pkt
17561100	Triple Skirt	TS7	Lumo/White	Three Per Pkt
17561101	Triple Skirt	TS8	Blue/White	Three Per Pkt
17561102	Triple Skirt	TS9	Green/Chart	Three Per Pkt

Zima Lures

Code	Model	Size	Colour	Unit
17460667	Zima Feathered	6"	Blue/White	Each
17460668	Zima Feathered	6"	Black/Purple	Each
17460669	Zima Feathered	6"	Clear/White	Each
17460670	Zima Feathered	6"	Green/Yellow	Each

Trolling Hooks

Code	Model	Style	Type	Material	Unit
17142019	Maruto	SS885	Bladed	Stainless Steel	Each
17145622	Mustad	78923X.21	Turkey Point	Stainless Steel	Each



Tuna trolling gear

Ashaway

Product Code	Model	Size	Weight	Length
		mm	lb	Foot / m
17460672	Ashaway F60161	3	300	275 / 84



Tuna Accessories

Code	Model	Size	Type	Test LB	Test KG
17391687	Swivels HD 3 Way	8mm x 7mm x 7mm	No Ring	500	227
17465300	Rubber Rings	382mm x 14.0mm	IRE038	N/A	N/A
17011007	Tuna Gloves	Size 9-11	Cut Free and Wet Grip	N/A	N/A

Cleaning Products

Code	Model	Type	Size
17556140	Chemetall	Metalbrite	20lt
17556143A	Kemsol	Citrus Clean	5lt
17556143	Kemsol	Citrus Clean	20lt
17556147	Kemsol	Citrus Clean	200lt
17556144	Kemsol	Big Kong Degreaser	20lt
17556146	Kemsol	Limesoft Hand Gel	5lt
17556148	Kemsol	Hypo 15% Chlorine	20lt

Radio Buoy

Product Code	Model	Part
17552469	KTR - 18	Radio Buoy
17552471	KTR - 18	Aerial Tip
17552473	KTR - 18	Aerial - Complete
17552479B	KTR - 18	Base Board Battery Pack

- ✓ 4 Tone Signal Series
- ✓ 3W - 10W
- ✓ DC-18V
- ✓ 1,650 - 4,000 KHz
- ✓ 200 NM
- ✓ 24.5kg

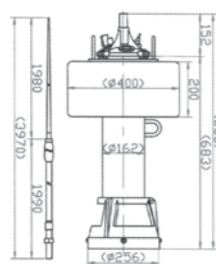

Lights

Strobes

High performance LED and strobe lights for longline applications.

Product Code	Model	Battery	Visibility	Flash Type	Flash Colour
			km		
17552391	Light Buoy CH 2000B	4x AA	3	LED	White
17552440	Sea Light DYX-285	2x D	6	Strobe	Red, White
17552441	Sea Light DYX-1	1x D	4	Strobe	Red, White



Underwater Lights

Gourock Underwater lights available in green, blue, white, and red. A disco option is also available. The lights feature a water activated on/off switch and are water proof to 700m.

Product code	Model	Flash type	Colour
17552366	Deluxe Power Light ZW-6	LED	Green, Blue & White
17552367	Deluxe Power Light ZW-7	LED	Green, Blue & Red
17552368	Deluxe Power Light DYP-200	LED	Disco



- ✓ Requires 2x AA batteries
- ✓ Impact resistant - do not break, shrink or deform.
- ✓ Do not absorb water, light weight with maximum surface buoyancy.
- ✓ Weather and UV resistant

Light Sticks

Code	Model	Size	Duration	Unit
17552454	Gloweez	4"	48hrs	2,000
17552454A	Gloweez	4"	48hrs	2,000



Batteries

Code	Model	Type	Size	Unit
17550431	Duracell	Alkaline	AA	4
17550435	Greencell	Extra Heavy Duty	D	20

Trace wire

Stainless Steel Trace Wire - Nylon Coating

Product Code	Construction	Coating	Diameter (mm)		Length m	Breaking Strength kg
			ID	OD		
17569276	Leader 7X7	Nylon	1.50	1.80	100	190
17569279	Leader 7X7	Nylon	1.80	2.10	100	268

Stainless Steel Trace Wire

Product Code	Construction	Diameter (mm)	Length m	Breaking Strength kg
		OD		
17569370	Leader 7X7	0.54	100	24
17569371	Leader 7X7	0.63	100	33
17569372	Leader 7X7	0.72	100	43
17569373	Leader 7X7	0.81	100	54
17569374	Leader 7X7	0.90	100	66
17569375	Leader 7X7	1.00	100	80
17569376	Leader 7X7	1.35	100	148
17569377	Leader 7X7	1.50	100	190
17569378	Leader 7X7	1.80	100	268
17569379	Leader 7X7	2.00	100	330

Seizing / Lacing Wire

Product Code	Model	Diameter	Length m	Coil Weight kg	Material
		mm			
17569479	Seizing Wire	1.2	110	1	Stainless Steel
17569482	Seizing Wire	1.8	110	1	Stainless Steel

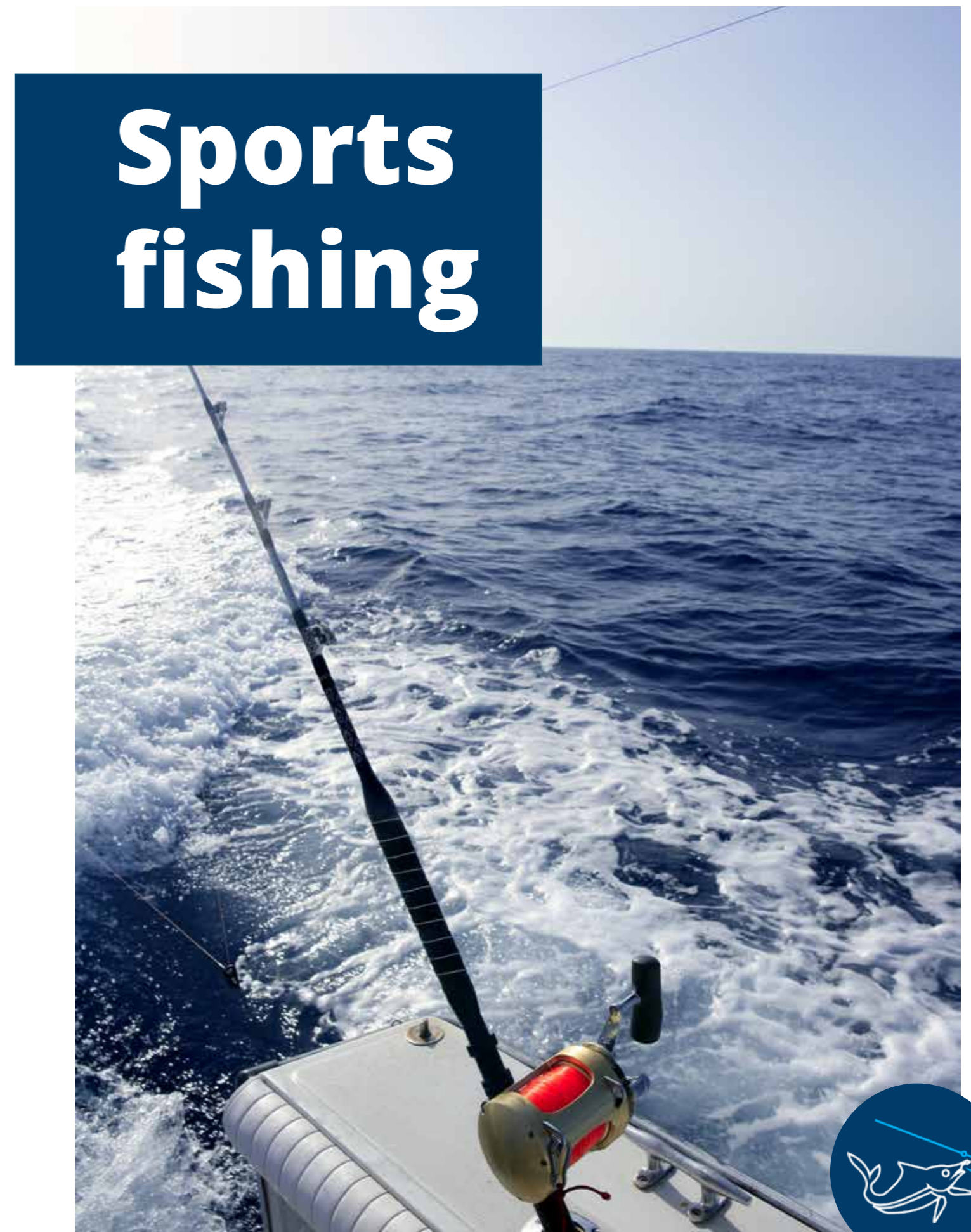

Momoi I.G.F.A. spools

Momoi's HiCatch IGFA monofilament nylon line is produced to exact tolerances and is designed to break just under IGFA specifications for each line class.

An extra margin of breaking strength over other IGFA lines is provided to tournament fishermen and world-record seekers without the worry of exceeding IGFA requirements.

Momoi IGFA ¼ lb Spools

Momoi IGFA 1/4 lb spools sold in fluoro yellow & light blue.

- ✓ Available in diameters between 0.145mm and 0.45mm
- ✓ 1 - 10 kg breaking loads
- ✓ Made in Japan



Momoi IGFA 4&5 LB Bulk Spools

Momoi IGFA 4 & 5 pound spools sold in fluoro yellow & light blue.

- ✓ Available in diameters between 0.40mm and 0.91mm
- ✓ 8 - 37 kg breaking loads
- ✓ Made in Japan

Momoi IGFA 300m & 1000m Spools

Momoi IGFA 4 & 5 pound spools sold in fluoro yellow & light blue.

- ✓ Available in diameters between 0.285mm and 1.17mm
- ✓ 4 - 60 kg breaking loads
- ✓ Made in Japan



Momoi I.G.F.A. spools

Momoi IGFA 1/4lb Spools

Product Code	Model	Spool lb	Colour	Load		Length m	Dia. mm
				kg	lb		
17221201	Momoi 1kg	¼	Light Blue	1	2	6,000	0.145
17221201F	Momoi 1kg	¼	Fluoro Yellow	1	2	6,000	0.145
17221202	Momoi 2kg	¼	Light Blue	2	4	3,000	0.20
17221202F	Momoi 2kg	¼	Fluoro Yellow	2	4	3,000	0.20
17221203	Momoi 3kg	¼	Light Blue	3	6	2,000	0.25
17221203F	Momoi 3kg	¼	Fluoro Yellow	3	6	2,000	0.25
17221204	Momoi 4kg	¼	Light Blue	4	8	1,500	0.285
17221204F	Momoi 4kg	¼	Fluoro Yellow	4	8	1,500	0.285
17221206	Momoi 6kg	¼	Light Blue	6	12	1,000	0.35
17221206F	Momoi 6kg	¼	Fluoro Yellow	6	12	1,000	0.35
17221206	Momoi 6kg	¼	Light Blue	6	12	1,000	0.35
17221208	Momoi 8kg	¼	Light Blue	8	16	750	0.40
17221208F	Momoi 8kg	¼	Fluoro Yellow	8	16	750	0.40
17221210	Momoi 10kg	¼	Light Blue	10	20	600	0.45



Momoi IGFA 4 & 5 lb Bulk Spools

Product Code	Model	Spool lb	Colour	Load		Length m	Dia. mm
				kg	lb		
17221108	Momoi 8kg	4	Ice Blue	8	16	12,000	0.40
17221108F	Momoi 8kg	4	Fluoro Yellow	8	16	12,000	0.40
17221110	Momoi 10kg	4	Ice Blue	10	20	9,600	0.45
17221110F	Momoi 10kg	4	Fluoro Yellow	10	20	9,600	0.45
17221115	Momoi 15kg	4	Ice Blue	15	30	6,000	0.57
17221115F	Momoi 15kg	4	Fluoro Yellow	15	30	6,000	0.57
17221140	Momoi 24kg	5	Ice Blue	24	50	4,500	0.74
17221140F	Momoi 24kg	5	Fluoro Yellow	24	50	4,500	0.74
17221142	Momoi 37kg	5	Ice Blue	37	80	3,000	0.91
17221142F	Momoi 37kg	5	Fluoro Yellow	37	80	3,000	0.91

Momoi I.G.F.A. spools

Momoi IGFA 300m Spools

Product Code	Model	Spool m	Colour	Load		Length m	Dia. mm
				kg	lb		
17221705	Momoi 4kg	300	Light Blue	4	8	300	0.285
17221706	Momoi 6kg	300	Light Blue	6	12	300	0.350
17221708	Momoi 8kg	300	Light Blue	8	16	300	0.400
17221710	Momoi 10kg	300	Light Blue	10	20	300	0.450
17221713	Momoi 15kg	300	Light Blue	15	30	300	0.570



Momoi IGFA 1,000m Spools

Product Code	Model	Spool m	Colour	Load		Length m	Dia. mm
				kg	lb		
17221606	Momoi 6kg	1,000	Light Blue	6	12	1,000	0.35
17221608	Momoi 8kg	1,000	Light Blue	8	16	1,000	0.40
17221608F	Momoi 8kg	1,000	Fluoro Yellow	8	16	1,000	0.40
17221610	Momoi 10kg	1,000	Light Blue	10	12	1,000	0.45
17221610F	Momoi 10kg	1,000	Fluoro Yellow	10	12	1,000	0.45
17221615	Momoi 15kg	1,000	Light Blue	15	30	1,000	0.57
17221615F	Momoi 15kg	1,000	Fluoro Yellow	15	30	1,000	0.57
17221624	Momoi 24kg	1,000	Light Blue	24	50	1,000	0.74
17221624F	Momoi 24kg	1,000	Fluoro Yellow	24	50	1,000	0.74
17221637	Momoi 37kg	1,000	Light Blue	37	80	1,000	0.91
17221637F	Momoi 37kg	1,000	Fluoro Yellow	37	80	1,000	0.91
17221660	Momoi 60kg	1,000	Light Blue	60	130	1,000	1.17
17221660F	Momoi 60kg	1,000	Fluoro Yellow	60	130	1,000	1.17



Leader line

Momoi Hi-Catch Leader Hank Coils

Momoi Hi-Catch leader line is an extremely high-quality monofilament line that exhibits very low memory characteristics and is very soft and flexible while maintaining a high-tensile strength-to-diameter ratio.

Product Code	Model	Coil Type	Length	Dia.
			m	mm
17221814	Hi-Catch 150 lb	Leader	100	1.28
17221819	Hi-Catch 200 lb	Leader	100	1.40
17221824	Hi-Catch 250 lb	Leader	100	1.60
17221829	Hi-Catch 300 lb	Leader	100	1.80
17221839	Hi-Catch 400 lb	Leader	100	2.05
17221846	Hi-Catch 480 lb	Leader	100	2.20



Momoi X-Hard Leader Hank Coils

Momoi's X-Hard nylon monofilament line is the ultimate leader material when extremely high tensile strength and abrasion resistance are required.

Produced with a hard outer coating to resist abrasion and for those applications where a stiffer leader is required.

Product Code	Model	Coil Type	Length	Dia.
			m	mm
17238147	X-Hard 300 lb	Leader	100	1.80
17238148	X-Hard 400 lb	Leader	100	2.05
17238149	X-Hard 500 lb	Leader	100	2.20
17238335	Momoi 650 lb	Leader	50	3.08

Momoi leader hank coils

Momoi's high strength monofilament and fluoro carbon combined with low stretch Dyneema® creates the strongest, most dependable wind-on leader in the world.

Product Code	Model	Coil Type	Length	Dia.
			m	mm
17238340	X-Hard Dyneema® 220 lb	Leader	11.3	1.45
17238345	X-Hard Dyneema® 300 lb	Leader	11.3	1.80
17238350	X-Hard Dyneema® 400 lb	Leader	11.3	2.05
17238355	X-Hard Dyneema® 530 lb	Leader	11.3	2.33



F.A.D

Fish Aggregating Device.



Rope

Wire Rope

Cookes offer an extensive range of steel wire ropes that can be utilised as part of an FAD system. Popular options for FAD Systems include:

- ✓ Stainless steel wire rope: 316 stainless wire rope preformed right hand ordinary lay, wire strand core.
- ✓ Combination wire rope: six strand combination rope (IWRC or fibre rope core), preformed steel strands covered with poly propylene multifilament.
- ✓ PVC coated wire rope: class A galvanised wire rope covered to required thickness with PVC, colour optional.

*To see our full range of wire ropes; see Cookes 2019 Wire Rope catalogue or view online at cookes.co.nz

Fibre Rope

Cookes offers an extensive range of fibre rope designed to meet the specific needs of your FAD system. Specialised and standard options are available in polyester, SuperDan, danline & nylon

*To see our full range of Fibre ropes, see Cookes; 2020 Fibre Rope catalogue or view online at cookes.co.nz



Super Dan

- ✓ High strength
- ✓ Durable
- ✓ Wide range of applications



Danline

- ✓ Strong & durable
- ✓ Fit for purpose
- ✓ Range of applications



Culture rope

- ✓ UV stabilised
- ✓ Balanced construction
- ✓ Spat collection & retention



Fibre rope

SuperDan & Polyester Ropes

Product Code	Model	Dia	Coil Size	B/L	Weight / Coil
		mm	m	kg	kg / m
18011160	SuperDan 12 S/T - Floating	16	1,000	4,500	116 / 1,000
18011204	SuperDan 12 S/T - Floating	20	900	6,900	161 / 900
18011254	SuperDan 12 S/T - Floating	25	500	9,900	130 / 500
18011324	SuperDan 12 S/T - Floating	32	220	16,800	101 / 220
18053186	Polyester 12 S/T - Sinking	18	500	7,400	117 / 500



Standard Fibre Rope Options

Product Code	Model	Dia	Coil Size	B/L	Weight / Coil
		mm	m	kg	kg / m
18010163A	PP Danline 3 S/T - Floating	16	220	3,800	32 / 250
18010203A	PP Danline 3 S/T - Floating	20	220	5,800	48 / 250
18010243A	PP Danline 3 S/T - Floating	24	220	8,100	72 / 250
18010283A	PP Danline 3 S/T - Floating	28	220	10,700	98 / 250
18042166A	Nylon 3 S/T - Sinking	16	220	4,780	39 / 250
18042203A	Nylon 3 S/T - Sinking	20	220	7,230	60 / 250
18042246A	Nylon 3 S/T - Sinking	24	220	10,200	87 / 250
18042286A	Nylon 3 S/T - Sinking	28	220	13,500	119 / 250
18050164A	Polyester 3 S/T - Sinking	16	220	4,100	49 / 250
18050204A	Polyester 3 S/T - Sinking	20	220	6,300	76 / 250
18050244A	Polyester 3 S/T - Sinking	24	220	9,100	109 / 250
18050284A	Polyester 3 S/T - Sinking	28	220	12,200	148 / 250



Culture Rope

Product Code	Model	Dia	Coil Size	B/L	Weight / Coil
		mm	m	kg	kg / m
18633014	PP Black Culture Rope 3 S/T - Floating	14	250	1,800	25 / 250



Wire rope & floats

Wire Ropes

Product Code	Model	Dia	Coil Size	B/L
		mm	m	kg
01940305	7x 19 RHOL 1620 SS	5	1.4	Stainless Steel
01940306	7x 19 RHOL 1620 SS	6	2.0	Stainless Steel
01940308	7x 19 RHOL 1620 SS	8	3.4	Stainless Steel
01940310	7x 19 RHOL 1620 SS	10	5.6	Stainless Steel
01983914	6x 9 RHOL 1570G Combination	14	4.3	PP + Galvanised
01983916	6x 9 RHOL 1420G Combination	16	6.2	PP + Galvanised
01799209	6x 19 RHOL 1420/1770G PVC Covered	13	5.5	PVC + Galvanised



F.A.D Floats

Product Code	Type	Model	Size	Working depth	Buoyancy	Weight
			mm	m	kg	kg
17060230	Centre Hole - Oval	309-2	290 x 437	200	20	3
17060208	Centre Hole - Spherical	10B-8	290 dia	800	10.8	3.1
17068280	EVA Purse Seine - Oval	SHE-70	220 x 250	Surface	6.5	1
17068285	EVA Purse Seine - Oval	SHE-80	248 x 265	Surface	8.5	1.3



F.A.D equipment

Swivels

Product Code	Type	Size	SWL	Length	Weight
		mm	ton	mm	kg
17393116	A16 FO Short Bow, Alloy Steel	16	2.4	150	0.87
17393119	A19 FO Short Bow, Alloy Steel	19	3.8	185	1.30
17393122	A22 FO Short Bow, Alloy Steel	22	5.3	230	2.20
17393223	A22 ST/W Large Eyes, Alloy Steel	22	5.3	260	2.75
17393125	A25 FO Short Bow, Alloy Steel	25	7.2	265	3.65
17390216	A16 SS Rigid, Stainless Steel	16	3.2	180	0.89
17390219	A19 SS Rigid, Stainless Steel	19	4.7	205	1.80
17390222	A22 SS Rigid, Stainless Steel	22	6.8	222	2.25
17390225	Rigid, Stainless Steel	25	8.3	278	4.10



Anchor Shackle - Green Pin

Product Code	Size	WLL	Inside L	Weight
	mm	ton	mm	kg
02329016	16	2.0	47.5	0.44
02329019	19	3.25	60.5	0.79
02329022	22	4.75	71.5	1.26
02329026	25	6.50	84.0	1.88
02329029	28	3.50	95.0	2.78



- ✓ Safety anchor shackle
- ✓ 6:1 safety factor, galvanized finish.
- ✓ Tested and certified.

F.A.D equipment

Chain

Product Code	Description	Finish	Size	MWL	Drum
			mm	ton	m
02605016	PWB Regular Link PC Chain	Galvanised	16	2,310	90
02605020	PWB Regular Link PC Chain	Galvanised	20	3,670	60
02605024	PWB Regular Link PC Chain	Galvanised	24	5,340	40
02609016	PWB Regular Link PC Chain	Self Colour (Black)	16	2,310	90
02609020	PWB Regular Link PC Chain	Self Colour (Black)	20	3,670	60
02609024	PWB Regular Link PC Chain	Self Colour (Black)	24	5,340	40



Crayfish

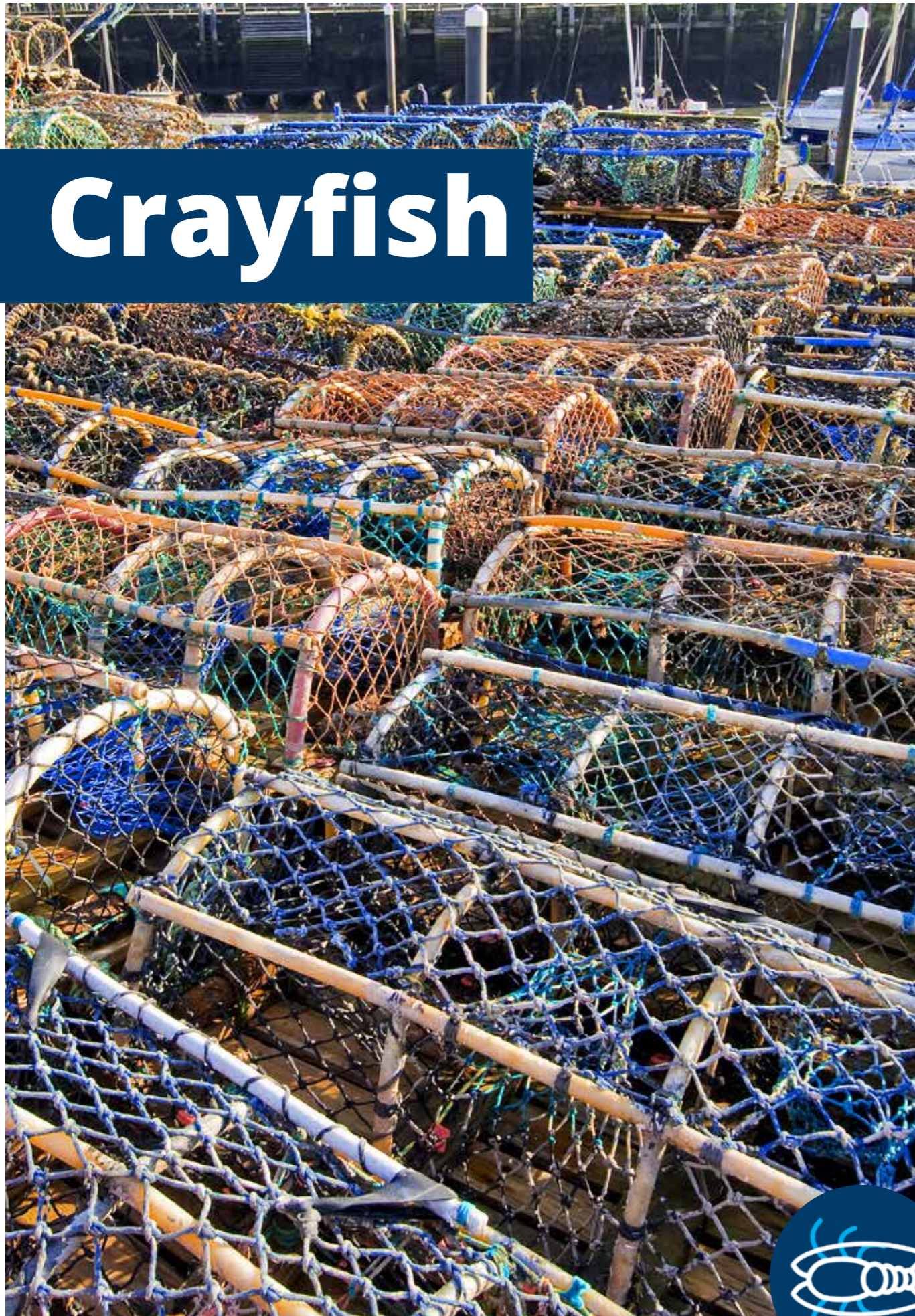

Cray Nets & Ropes

HDPE Craypot Netting

Cookes offer a range of netting for craypots available in lengths of upto 180m.

Product Code	Model	Ply Size	Mesh Size		Dimensions	
			in	mm	MD	Length (m)
17323010	PE 380D	60	3	76	20	180
17323016	PE 360D	60	3	76	50	180
17324122	PE 380D	120	3	76	20	90

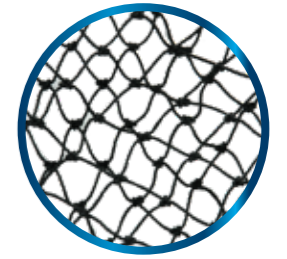

- ✓ High strength, good abrasion
- ✓ Cost effective pot netting

Gourock Southern Cray Rope

Southern Cray Rope with a three strand medium to hard lay finish and 250m in length.

Colour	Diameter (mm)	Length	Unit	Weight	Break Load
		m		kgs/100m	kg
Green/Yellow	8	220	Coil	3.0	1,200
Green/Yellow	9	220	Coil	3.8	1,500
Green/Yellow	10	220	Coil	4.5	1,800
Green/Yellow	12	220	Coil	6.6	2,700
Green/Yellow	14	220	Coil	9.1	3,600



- ✓ Excellent anti-abrasion
- ✓ High UV resistance
- ✓ Superior strength



Cray floats & buoys

Polyform Inflatable Low Drag Buoys

Inflatable low-drag buoys from Polyform. These buoys offer high UV resistance and ribbed design that create reduced drag compared to standard round buoys.

Offered in a range of colours & designs, these buoys offer excellent value.

Product Code	Model	Nett Buoyancy kg	Eye Dia. mm	Dimensions (mm)			Colour
	Polyform			L	Dia.	Circ.	
17063690	LD-1	13	25	470	215	270	Orange
17063691	LD-1	13	25	470	215	270	Red
17063692	LD-2	31	25	590	305	377	Red
17063692A	LD-2	31	25	590	305	377	Yellow
17063692B	LD-2	31	25	590	305	377	Orange
17063692C	LD-2	31	25	590	305	377	Saturn Yellow
17063693	LD-3	55	25	760	360	449	Red



- ✓ Unique upright shape ensures maximum visibility
- ✓ Ribbed design creates only 20% of the drag of standard round buoys
- ✓ Featured buoy in the "Deadliest Catch" series on the Discovery Channel®

Crayfloat Markers

Gourock crayfloat marker buoys. Our buoys are New Zealand made and are available in a variety of colours.

Buoys are 200mm in diameter and feature an eye diameter of 21mm.

- ✓ Black
- ✓ Blue
- ✓ Red
- ✓ Green
- ✓ Orange
- ✓ Pink
- ✓ White
- ✓ Yellow



Sheave blocks

BMM Blocks (Blueline) - Galvanised, Steel Sheave

Product Code	Model	Bearing Type	SWL (ton)	Max Wire (mm)	Dim. (mm)		Sheave Dia. mm	Weight kg
					H	W		
17182821	KT 1 - 1E (Sgl sheave)	Ball Bearing	1.0	16	163	22	80	1.7
17182821A	KT 1D - 1E (Dbl sheave)	Ball Bearing	1.0	16	187	44	80	3.1
17182822	KT 1 - 1E (Sgl sheave)	Sealed Ball Bearing	2.0	18	195	24	110	3.1
17182822A	KT 1D - 1E (Dbl sheave)	Sealed Ball Bearing	2.0	18	224	48	110	5.2



BMM Blocks (Blueline) - Snatch Block, Bronze Bushing

Product Code	Model	Top Head	SWL	Height	Sheave		Weight kg
			ton	mm	Dia	Width	
17182841	KS 20 - E	Swivel eye	1.5	220	83	45	5.4
17182842	KS 40 - E	Swivel eye	3.5	250	100	45	7.5



BMM Blocks (Blueline) - Galvanised, Nylon Sheave

Product Code	Model	SWL (ton)	Max Wire (mm)	Dim. (mm)		Sheave Dia. mm	Weight kg
				H	W		
17182837	KT 1 - NE (Sgl sheave)	1.0	16	163	22	80	1.3
17182837A	KT 1D - NE (Dbl sheave)	1.0	16	187	44	80	1.9
17182838	KT 2 - NE (Sgl sheave)	2.0	18	195	24	110	2.1
17182838A	KT 2D - NE (Dbl sheave)	2.0	18	224	48	110	3.3
17182839	KT 3 - NE (Sgl sheave)	3.0	20	257	28	150	4.1
17182839A	KT 3D - NE (Dbl sheave)	3.0	20	296	56	150	6.6



- ✓ The Safe Working Load indicates the maximum mass or force that the block is able to support.
- ✓ All blocks must be inspected regularly to monitor condition.
- ✓ Each block may be affected by wear, misuse, overloading, deformation and other use conditions.
- ✓ Shock loading and abnormal conditions must be taken into account when selecting blocks.

Accessories

Clothing & equipment

Safemate Foot Wear

Available in sizes from 7-14, featuring steel toe caps and oil/acid and slip resistant soles.



Stormline Double Front Bib

Ranging in sizes S - 4XL and featuring:

- ✓ Heavy-duty polyester-backed PVC outer layer and nylon-backed PVC against skin for quick drying.
- ✓ Triple layer in the knee incorporating removable knee pads. Elasticated braces with industrial plastic clip buckles.
- ✓ Reinforced with tape at stress points. Velcro tape at legs for adjustment & safety.
- ✓ Elastic waist, hi-visibility neon for safety. Ideal for environments requiring abrasion resistant gear.



Stormline Crew Jackets

Ranges in sizes from S - 3XL and features;

- ✓ Velcro storm flap, drawstring storm hood, and neoprene adjustable cuffs for water protection and comfort.
- ✓ Shorter front to reduce bulk with longer back for added water protection.
- ✓ Featured in mostly neon for hi-visibility, the jacket also features white reflective tape for superior reflective performance in all conditions and enhanced safety and identification.
- ✓ Ideal for environments requiring abrasion resistant gear.



Gloves

Our gloves come in a range of models and sizes to suit your requirements.



Product Code	Model	Type	Size	Colour
17011001-003A	Nylon Gloves	Nylon	SM - XL	Coloured Trim
17011009A	Cotton	Cotton 342K	LG	White/ Yellow Trim
17011050	Double Dipped	PVC 45cm	LG	Green
17011100A	Dyna Grip	DG 40cm	LG	Orange
17011539	Slurry	PVC 62CM	LG	Blue
17011713MB	Laytex	MDLL	LG	Clear

Knives

Hot Knives

HSGM 240v Hot Knives available with or without type R blade. Blades sold individually.

Product code	Brand	Model	Blade Type
17551992	HSGM Hot Knife	240V	Type R Blade (additional)
17551993	HSGM Hot Knife	Blade (only)	Type R Blade



Fish Knives

Godard Victory fish knives available in a variety of models.

Product Code	Model	Blade Type	Blade Length
			cm
17552063	Serrated 341	S/S Serrated	22
17552070	Cabbage 308	S/S Straight	30
17552075	Fish Splitter - Heavy Duty	S/S Straight	30
17552080	Fish 307	S/S Straight	17
17552090	Heading Fillet 307	S/S Straight	22
17552100	Heading Fillet 802	S/S Straight	22
17552135	Thin Fillet 512	S/S Straight	18
17552141	Fillet 506	S/S Straight	22
17552142	Narrow Fillet 250625	S/S Straight	25

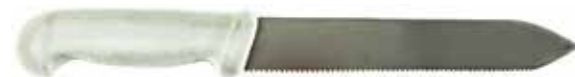

17552063



17552070



17552075



17552080



17552090



17552135



17552141

Knives

Butchers Knives

Godard Victory stainless steel butcher's knives, available in a range of sizes and models.

Product Code	Model	Blade Type	Blade Length
			cm
17552057	Boning Knife 710	Stainless Steel	15
17552058	Boning Knife 710	Stainless Steel	17
17552059	Boning Knife 223	Stainless Steel	17
17552086	Y-Cut Knife 207	Stainless Steel	15
17552087	Y-Cut Knife 207	Stainless Steel	17
17552099	Fillet Knife 210	Stainless Steel	19



17552057



17552087



17552058



17552099

Kazax Hi-Cut Fish Knives

Kazax Hi-Cut fish knives available in two lengths 15cm and 21cm featuring a straight stainless steel blade with sheath.



17552032

Japanese Knives

Magiri-Deck carbon steel straight knife. 13.5cm in length.



17552164

Vegetable Knives

Victorinox stainless steel serrated vegetable knife. 8cm in length.



17552043

Knives

Frost Knives

10cm Frost stainless steel knives available in a variety of models.

Product Code	Brand	Model	Blade Type	Blade Length
				cm
17552229	Frost	Frost Clipper Knife #860	S/S Straight	10
17552217	Frost	Sabre Clipper Knife #861	S/S Serrated	10



Sharpeners

Product Code	Model	Size	Blade Type
17552233	Flugal Butchers Steel	12"	Medium
17552236	Combination Stone	8"	Coarse / Medium



Tools

Mono Cutters

HSMC-400 serrated & machined stainless-steel mono cutters.



17569750

Scissors

Gold Leaf smooth machined stainless steel scissors.



17555723

Saw

Product Code	Model	Type	Blade Size	Material
17555022	Wells	Saw Complete	20"	Aluminium
17555023	Wells	Spare Blade	20"	Stainless Steel

Heavy Duty Bench Crimper CT1000

Product Code	Model	Weight	Dimensions (mm)		
		Kg	L	W	H
17460601	CT - 1000	11.0	700	125	270



CT1000 Dye Sets

Product Code	Model	Hole Size	Sleeve Size
		mm	mm
17460602	CT - 1000 A	7.0	4.3
17460603	CT - 1000 B	5.7	3.3
17460604	CT - 1000 BC	5.0	2.8
17460605	CT - 1000 C	4.6	2.6
17460606	CT - 1000 D	4.3	2.3
17460607	CT - 1000 E	3.9	2.0
17460608	CT - 1000 F	3.6	1.7



Hand Crimpers

Product Code	Model	Number of Crimping Positions	Crimp Size	Length		Jaw Material
			mm	mm	in	
17460614	CN - 10	4	0.1 - 2.2	-	-	Steel
17460609	CH-18	4	1.0-4.2	406.4	16	Steel



Splicing tools

Splicing Fids

Product Code	Model	Material		Length (mm)
		Handle	Spike	
17551810	EM 170	Wood	Stainless Steel	170
17551812	MDR 220	Wood	Stainless Steel	220
17551826	MDR 290	Wood	Stainless Steel	290
17551827	MDR 360	Wood	Stainless Steel	360



Marlin Spikes

Product Code	Model	Material		Dimensions (mm)		Weight kg
		Tip	Spike	H	Dia.	
17551831	EM 260	Hardened	Chrome Steel	260	28	0.24
17551832	EM 310	Hardened	Chrome Steel	310	28	0.37
17551833	EM 450	Hardened	Chrome Steel	450	43	1.21
17551834	EM 610	Hardened	Chrome Steel	610	43	1.88



Punches

Product Code	Model	For connector	Dimensions (mm)			Weight kg
			Size	W	H	
17182381	E600-07	10	7	22	190	0.36
17182382	E600-09	13	9	22	210	0.41
17182383	E600-11	16	11	22	220	0.45
17182384	E600-13	19	13	22	240	0.5
17182385	E600-15	22	15	22	250	0.55
17182386	E600-17	26	17	22	265	0.65



Net needles

Osprey Needles

Product Code	Size		Part #
	in	mm	
17552580	10	250	NAL10
17552582	12	300	NAL12
17552584	14	350	NAL14
17552586	16	400	NAL16



Toka Needles

Product Code	Size		Part #
	in	mm	
17552530	8	203	MAAL451
17552540	10	250	MAAL452
17552550	12	300	MAAL453



Blueline Needles

Product Code	Size		Part #
	in	mm	
17552480	5	127	NAL F1040
17552490	7	178	NAL F1041
17552500	8	203	NAL-F987



Sundry

Hand GAFF

Product Code	Model	Length	Material	Prongs
		mm		
17551860	Short - STD	450	Wooden	1
17551861	Medium - STD	600	Wooden	1
17551862	Long - HVDTY	800	Wooden	1



Gaff Hooks

Norwegian 4 hook GAFF.

Product Code	Model	Material	Prongs
17551863A	GAFF	Stainless Steel	4



Reflective Tape

HR1 & HR2 Reflective tape. Sold in silver & yellow at 47.5m in length.

Product Code	Model	Colour	Length
17555152	Reflective tape	Silver	47.5
17555162	Reflective tape	Yellow	47.5



Sundry

King Gong Scrubber & Deck Brush

King Gong Scrubber hand brush & deck brush.

Product Code	Model	Colour
17555751	Deck Scrubing Brush	White
17555752	Hand Scrubbing Brush	White



Sundry Tubing

Cookes offer sundry tubing in 200m lengths, available in 4.2mm dia in green, pink and a clear 2.5mm dia tubing.



Net Solutions

New Zealand's leading, supplier, manufacturer, and service provider for net solutions.

Our team of net makers have over 50 years' experience across the fishing and aquaculture sectors. We pride ourselves on being able to offer high-quality advice and services that add value



Fishing & Aquaculture

We are the leading supplier of aquaculture nets to the New Zealand Salmon farming industry. We supply grower nets, predator nets, and bird nets that are engineered and manufactured to the specific requirements of each customer and farm.

Cookes provides net design services, manufacture (nets only), alteration, splicing, and repair services for all types of netting and rope products from our three specialised net loft service centres/netting facilities in Nelson, Timaru, and Picton.

Additional services from these facilities include:

- ✓ Disinfection
- ✓ Wash down
- ✓ Repair
- ✓ Net strength testing
- ✓ Net recycling

Cookes proudly partners with one of the world's leading net manufacturers for the aquaculture industry, Garware Technical Fibres. This partnership allows Cookes to access world-leading net technology and innovation that can provide increased value, productivity, and safety.

We also work closely with the New Zealand fishing industry to develop and assess new net technologies that ensure our customers have access to leading solutions that generate the best catch rates and reduce environmental impact

We provide nets for:

- ✓ Wing trawls
- ✓ Scampi trawls
- ✓ Bottom trawls
- ✓ Mid water trawls
- ✓ Cod-ends

Rope splicing

We specialise in splicing of all types of ropes and the manufacture of Dyneema® Heli lines. Both Dyneema® Fibre and Dyneema® rope slings are fully certified and ready for service. We also offer a full measure, installation, and regular inspection and certification service to ensure customer-specific needs are met..

Cookes has three netlofts across the South Island:

- ✓ Picton
- ✓ Nelson
- ✓ Timaru



LOCAL EXPERTISE

Our locations.

AUCKLAND HEAD OFFICE
6 - 10 Greenmount Drive
East Tamaki
Auckland 2013
customerservices@cookes.co.nz
Phone: +64 9 274 4299

WHANGAREI
239 Lower Port Road
Whangarei 0174
whgsales@cookes.co.nz
Phone: +64 9 438 8964

HAMILTON
17 Tasman Road
Avalon
Phone: 0508 274 366

ROTORUA / NAPIER
59 Marguerita Street
Rotorua 3010
rotsales@cookes.co.nz
Phone: +64 7 348 3042

TAURANGA
1 Marsh Street
Tauranga 3110
tausales@cookes.co.nz
Phone: +64 7 578 0605

NEW PLYMOUTH
72 Corbett Road
Bell Block, RD3
New Plymouth 4312
npysales@cookes.co.nz
Phone: +64 6 755 0413

WELLINGTON / PALMERSTON NORTH
57 Cuba Street
Petone, Wellington 5012
wtmsales@cookes.co.nz
Phone: +64 4 568 4384

NELSON
8 Akersten Street
Port Nelson 7010
nelsales@cookes.co.nz
Phone: +64 3 548 0719

CHRISTCHURCH
124C Waterloo Road
Christchurch 8042
chcsales@cookes.co.nz
Phone: +64 3 349 3002

TIMARU
66 Seadown Road
Timaru 7910
timsales@cookes.co.nz
Phone: +64 3 684 7494

DUNEDIN
2A Orari Street
Dunedin 9012
dunsales@cookes.co.nz
Phone: +64 3 455 3966

INVERCARGILL
137 Clyde Street
Invercargill 9810
invsales@cookes.co.nz
Phone: +64 3 218 4682

COOKES

a BRIDON · BEKAERT Ropes Group Brand

contact@cookes.co.nz

www.cookes.co.nz



facebook.com/cookesbbrg



linkedin.com/company/Cookes



twitter.com/bridonbekaert

Head Office

Bridon New Zealand Limited
trading as **Cookes**

6-10 Greenmount Drive, East Tamaki
PO Box 14 422, Panmure

Auckland

0508 274 366

+64 9 274 4299

Disclaimer:

Whilst every effort has been made to ensure the accuracy of information in this publication, no guarantee or warranty (expressed or implied) is given with respect to the accuracy or completeness of the information contained within. This publication and the products described herein may be changed or updated without notice. Any and all liability whatsoever for any loss or damage arising, directly or indirectly, out of or in connection with the use of this publication, is excluded to the fullest extent permitted by law. The user must determine the suitability of the product for their own particular purpose, either alone or in combination with other products and shall assume all risk and liability in connection therewith. This document is published by Bridon New Zealand Ltd. Use of this publication shall be governed in accordance with the laws of New Zealand courts and shall have exclusive jurisdiction over any dispute concerning your use of this publication.

Intellectual Property:

All rights reserved. No parts of this publication may be reproduced or transmitted in any form or by any means without the prior written permission of the copyright holder, application for which should be addressed to Bridon New Zealand Ltd.

Edition 02/2020 Cookes Fishing Catalogue

BRIDON · BEKAERT
THE ROPES GROUP